

E4S Air Cushion Machine and ET400 Separator Small Frame Installation Instructions Rev00

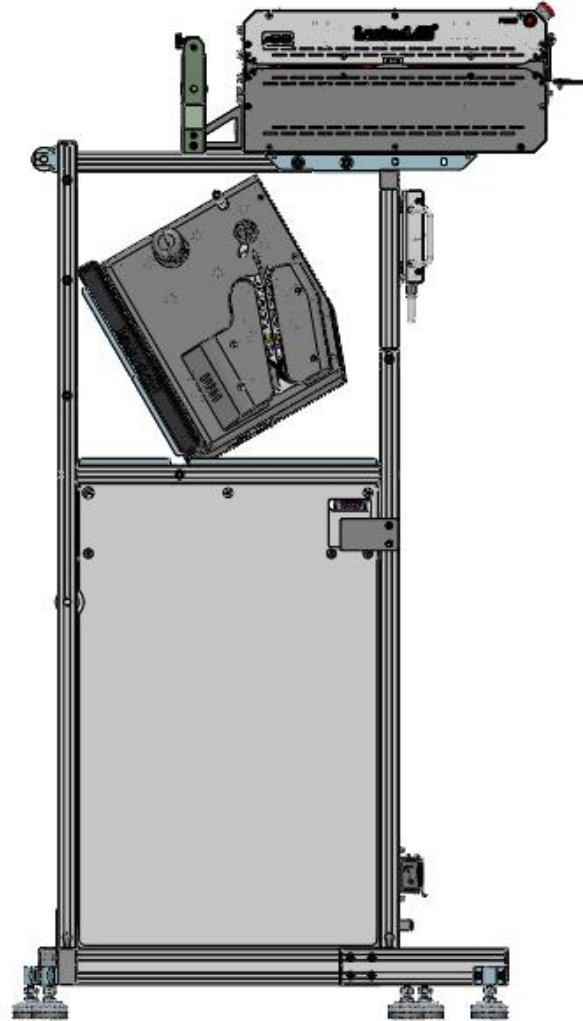

(LA-E4S Air Cushion Machine & ET-400 Separator)

Tools should be prepared in advance by yourselves:

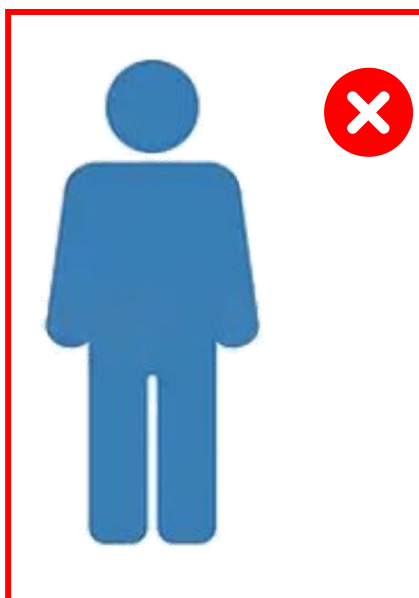
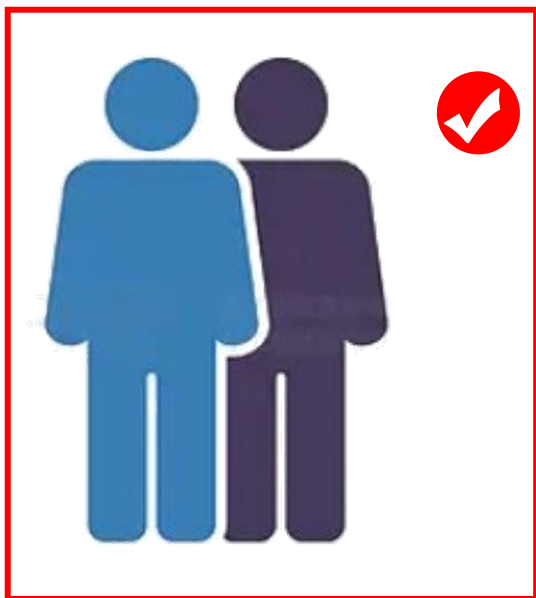

Operation Contents:

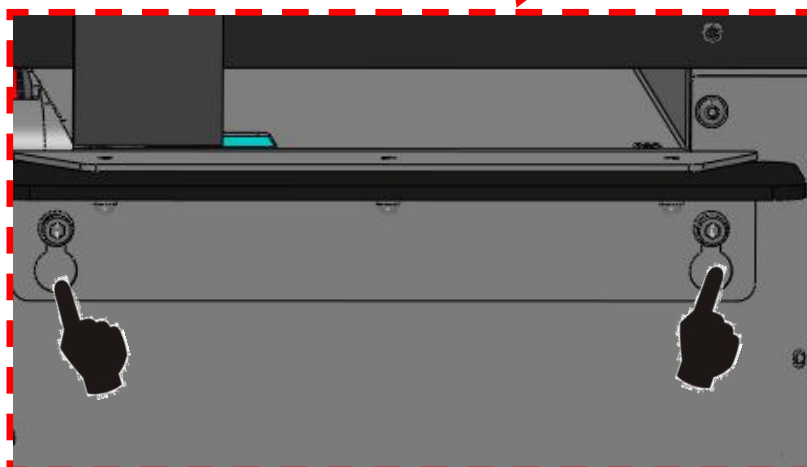
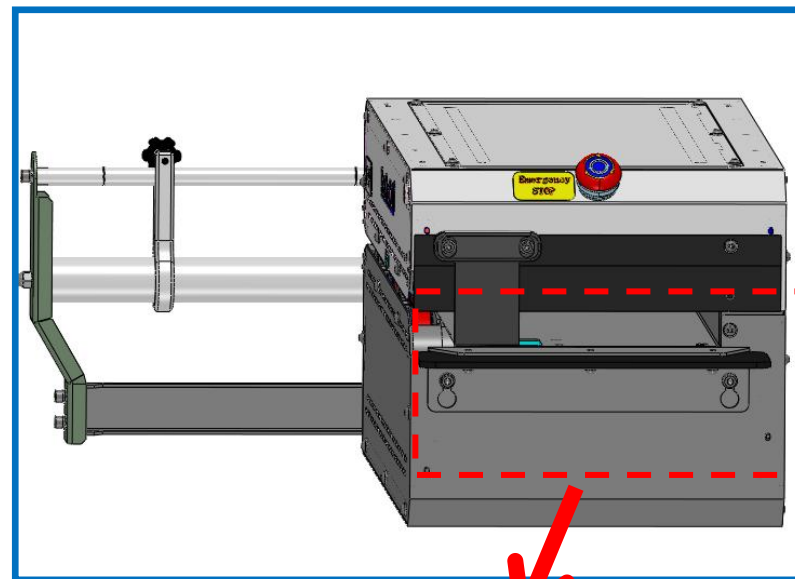
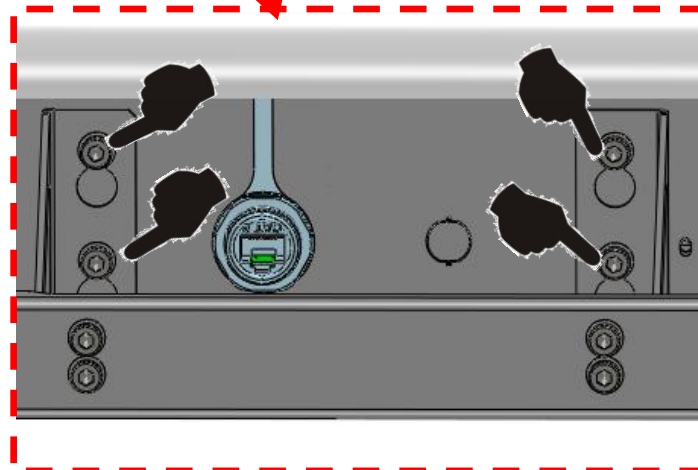
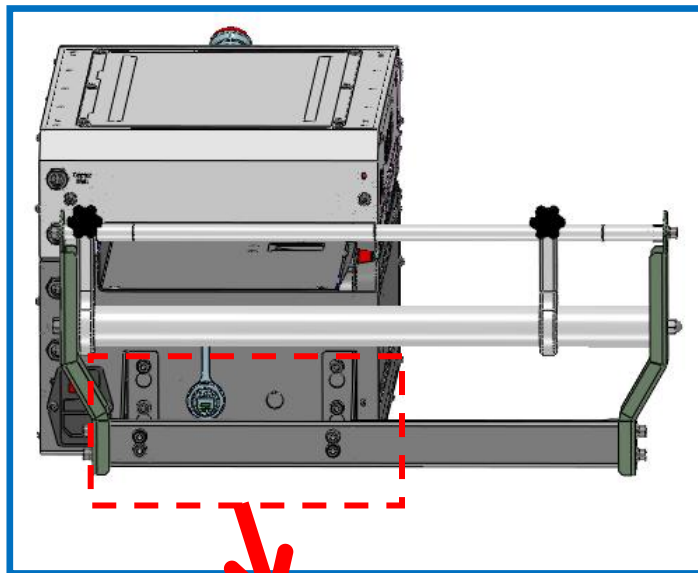

Allen wrench M5

Operation Contents:

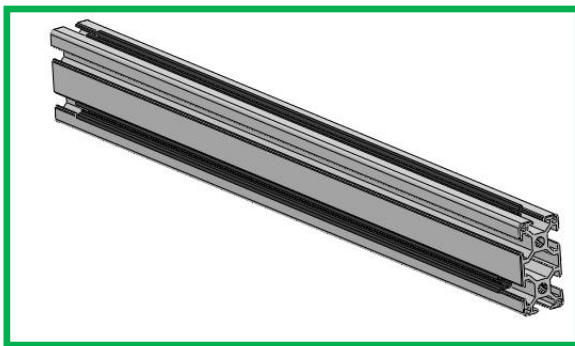
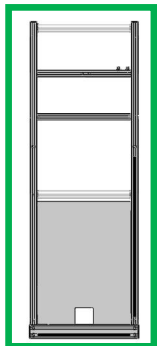

Before installation,
peel off the film
from the PVC
board.

D: Back Bracket

M: 3060
Aluminium
Profiles 1



Allen wrench M8

2 -Screw M8×35



Operation Contents:

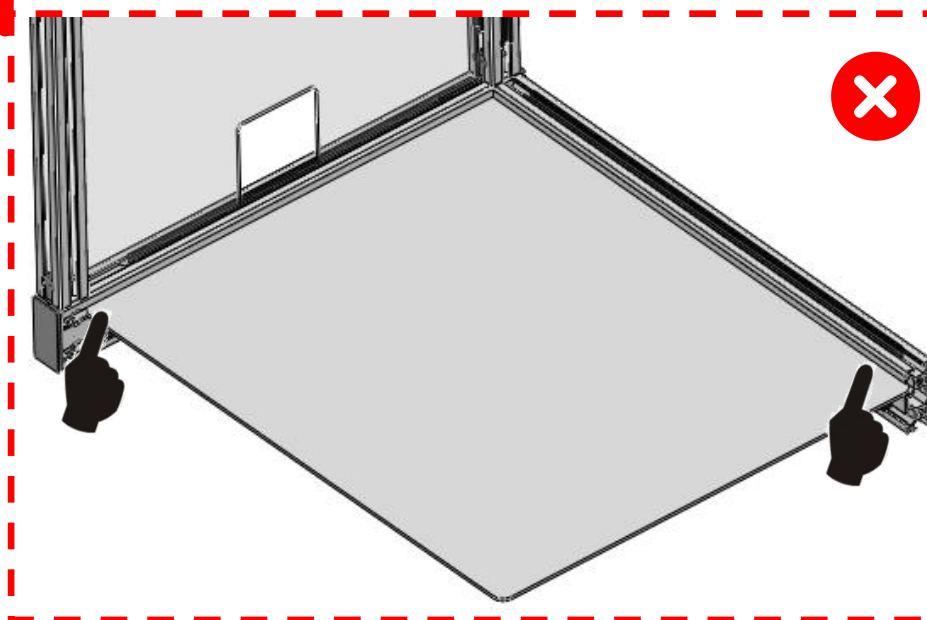
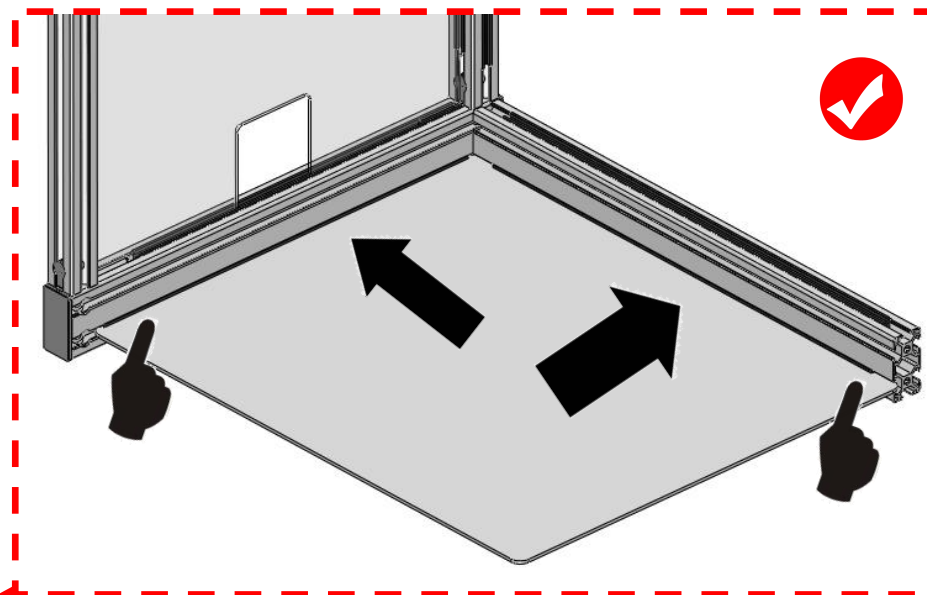
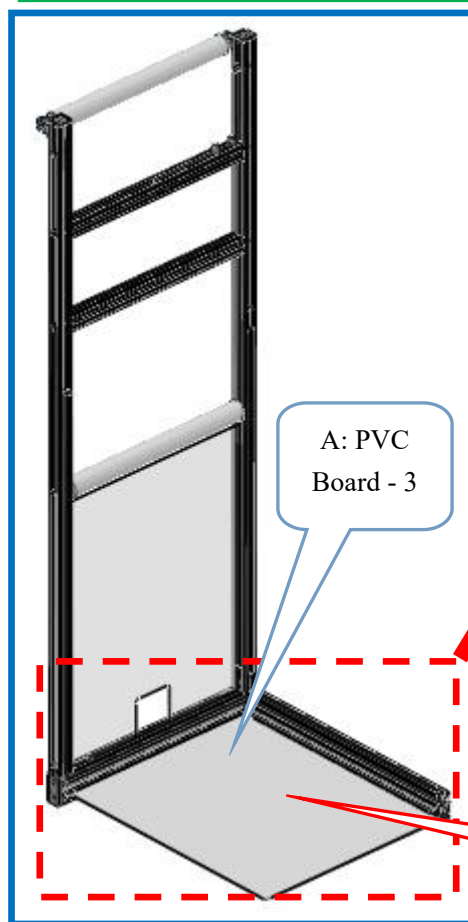
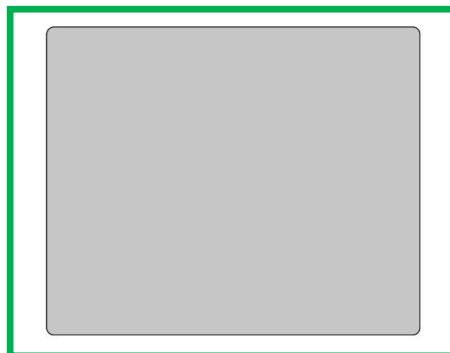

Before installation, peel off the film from the PVC board.

Operation Contents:

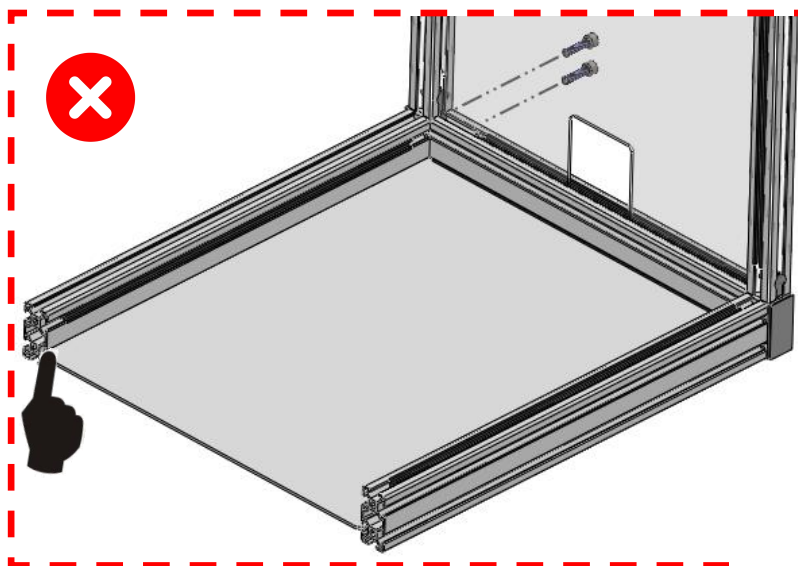
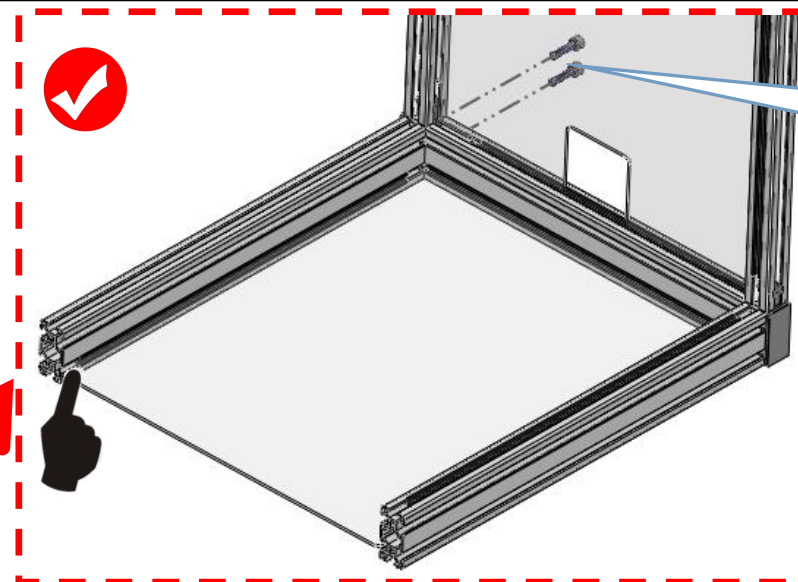
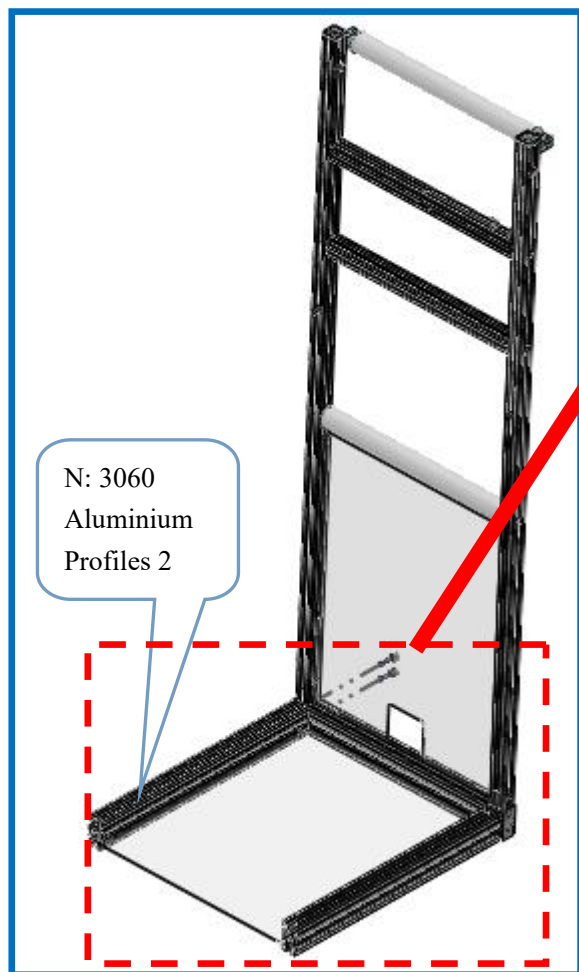
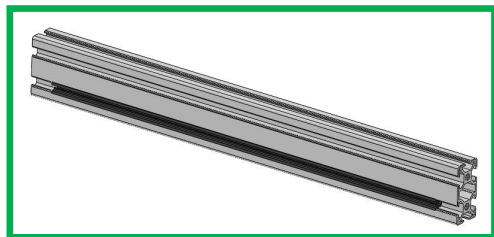

Allen wrench M8

Operation Contents:

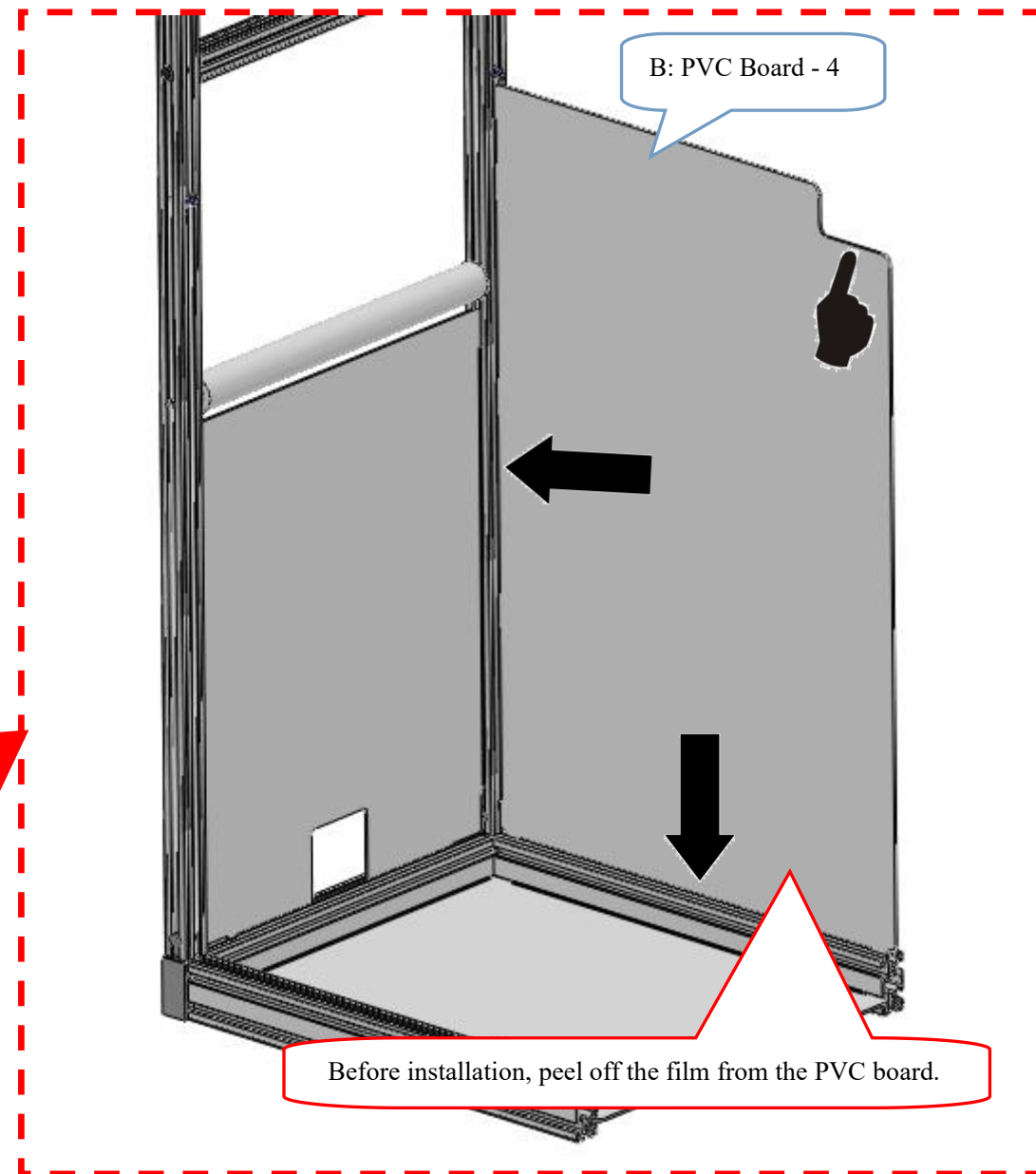
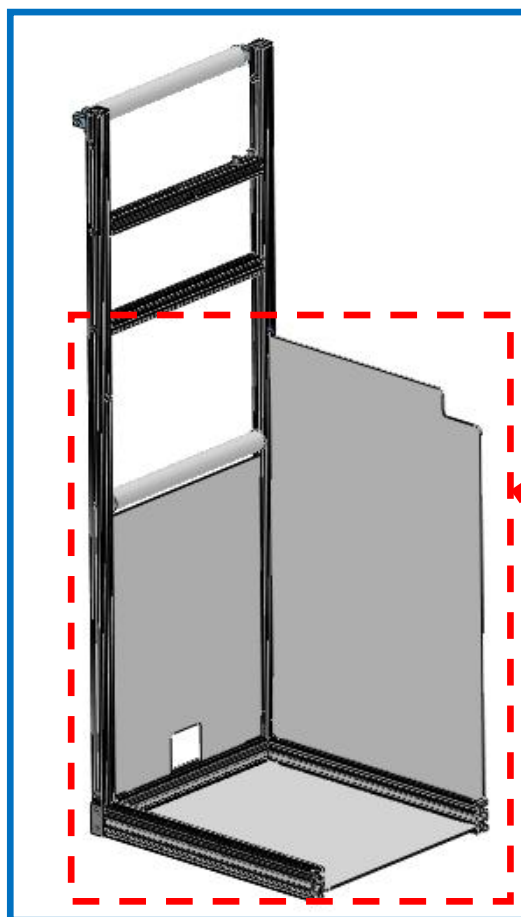
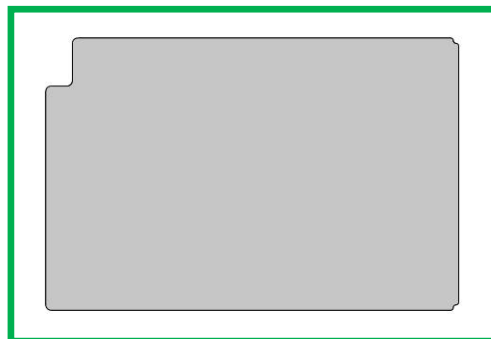

Operation Contents:

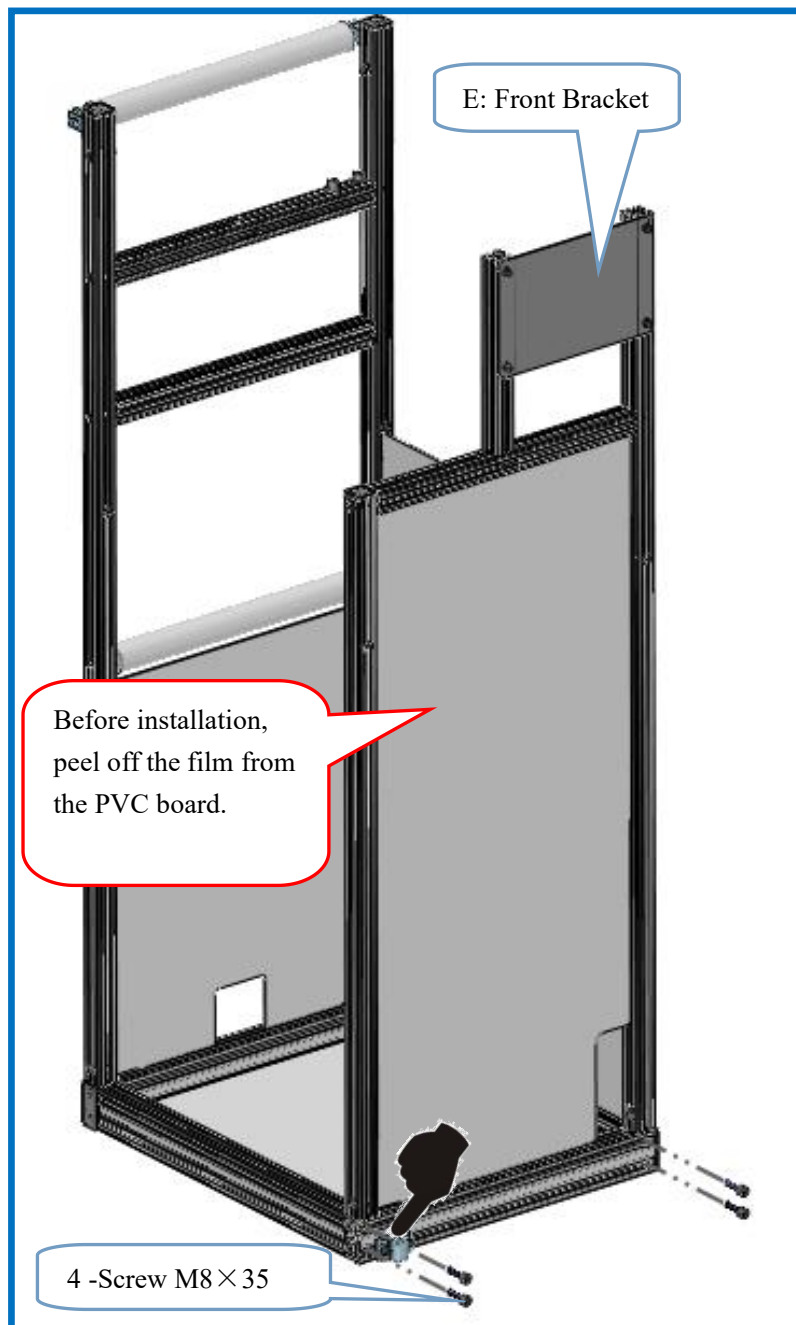
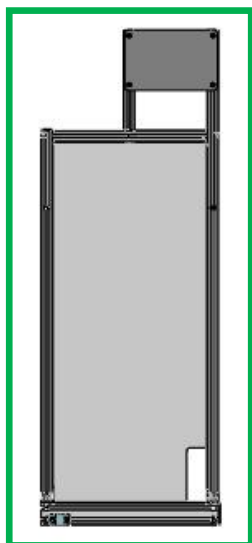

Allen wrench M8

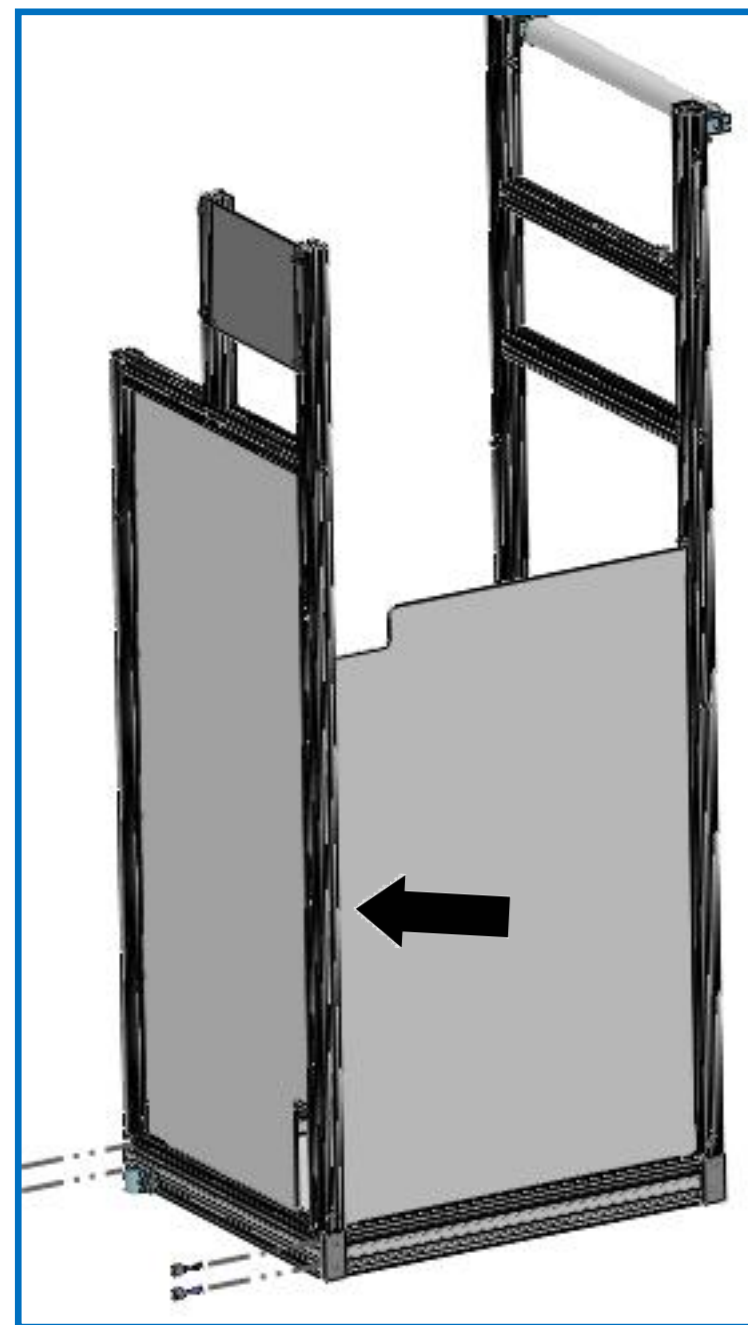

Operation Contents:

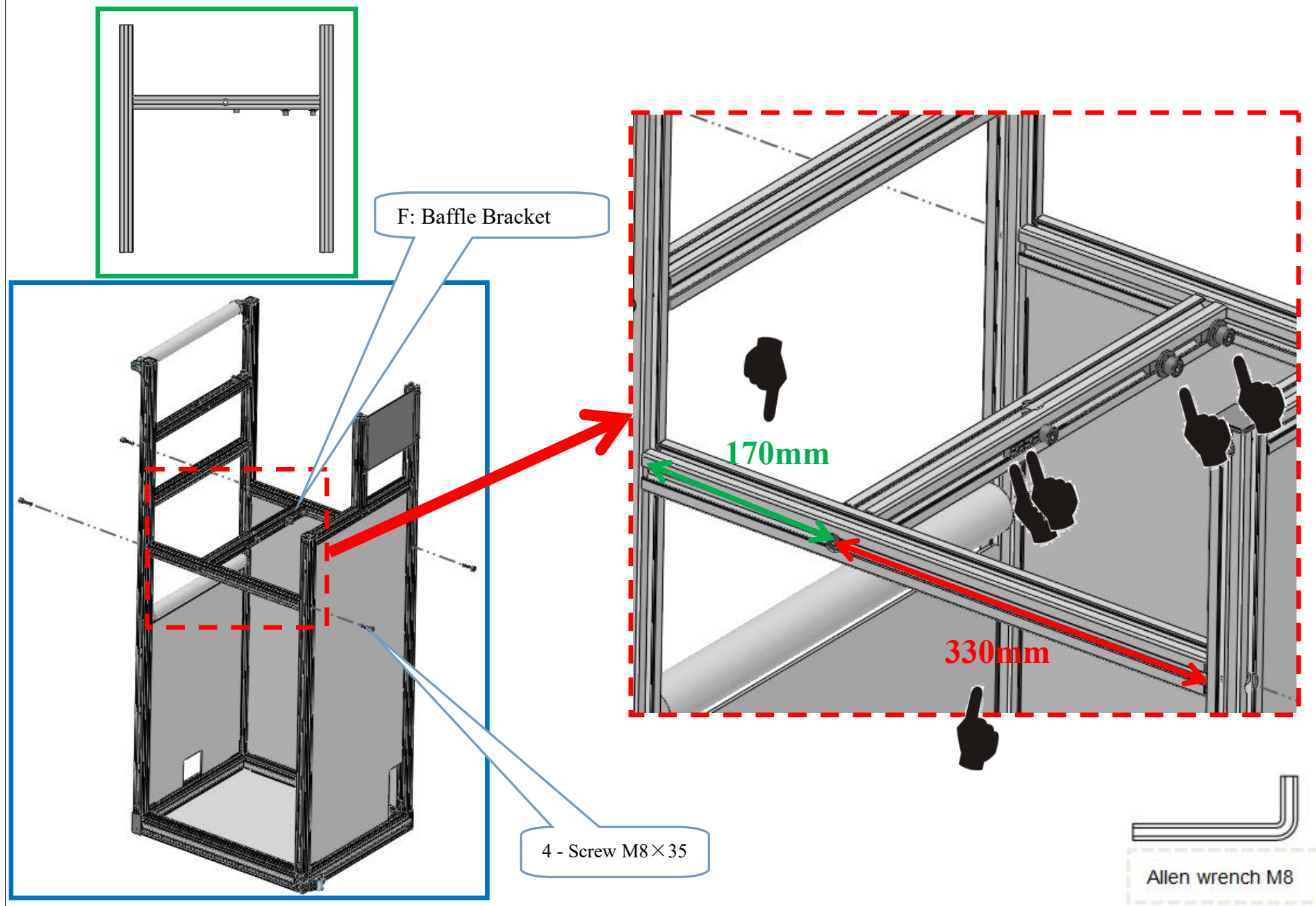

Operation Contents:

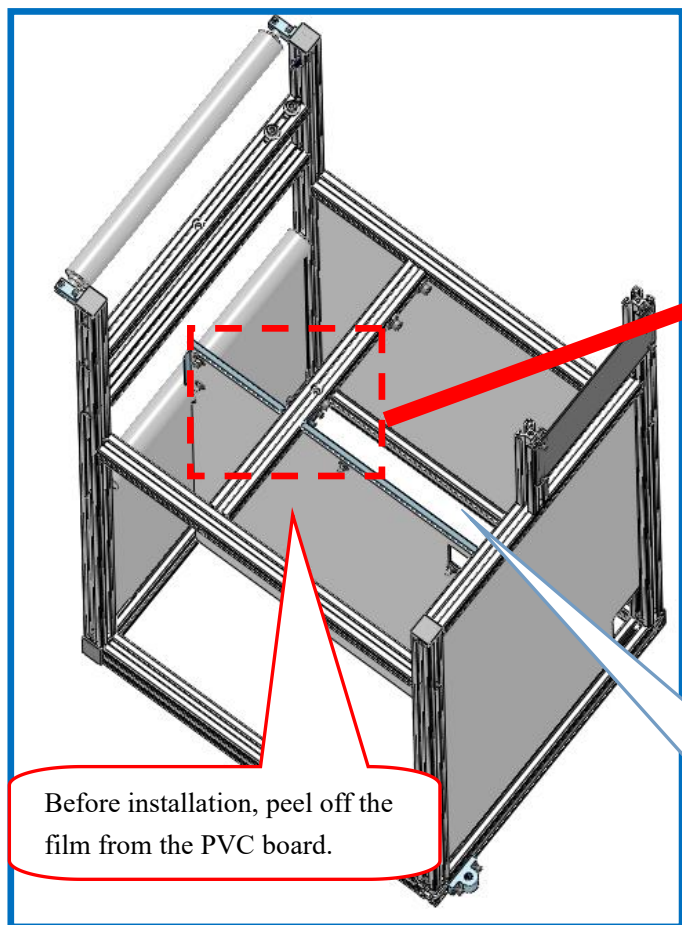
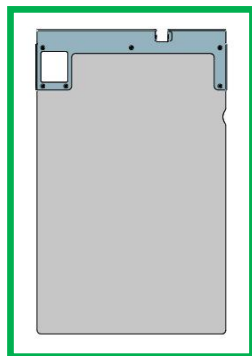

Before installation, peel off the film from the PVC board.

C: Baffle Assembly

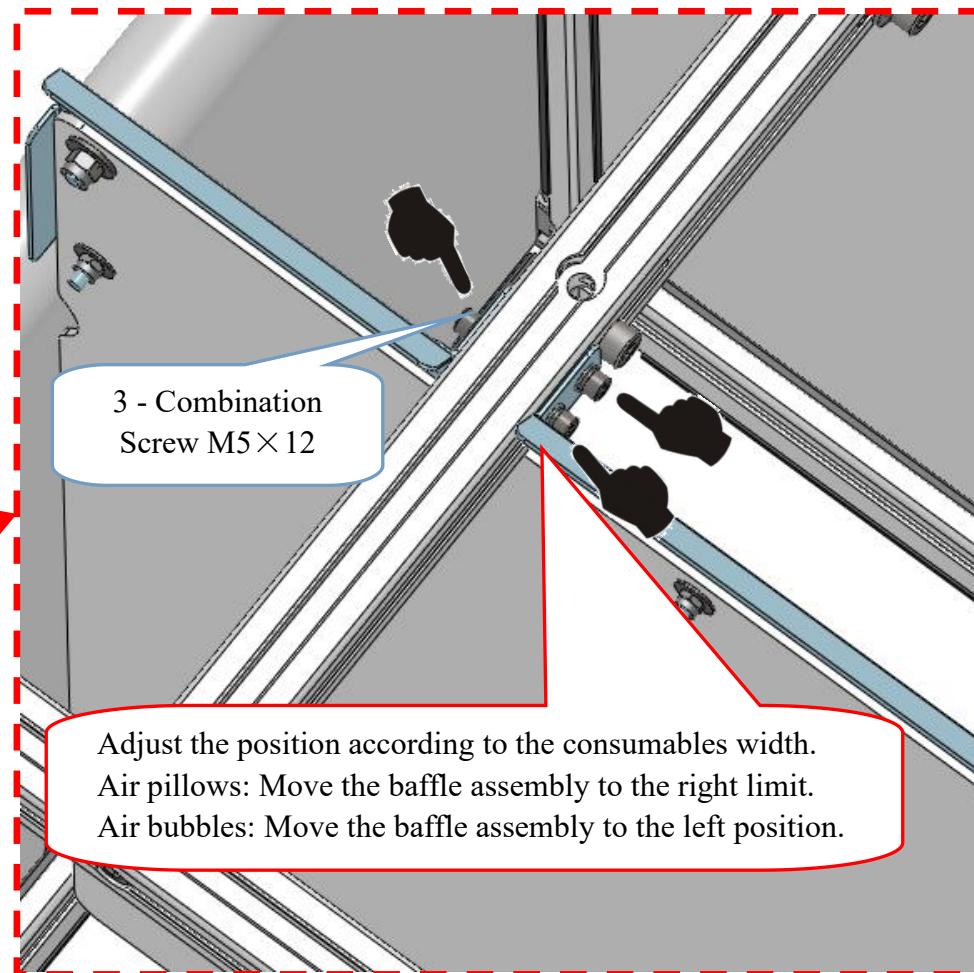

3 - Combination
Screw M5 x 12

Adjust the position according to the consumables width.
Air pillows: Move the baffle assembly to the right limit.
Air bubbles: Move the baffle assembly to the left position.



Allen wrench M5

Operation Contents:

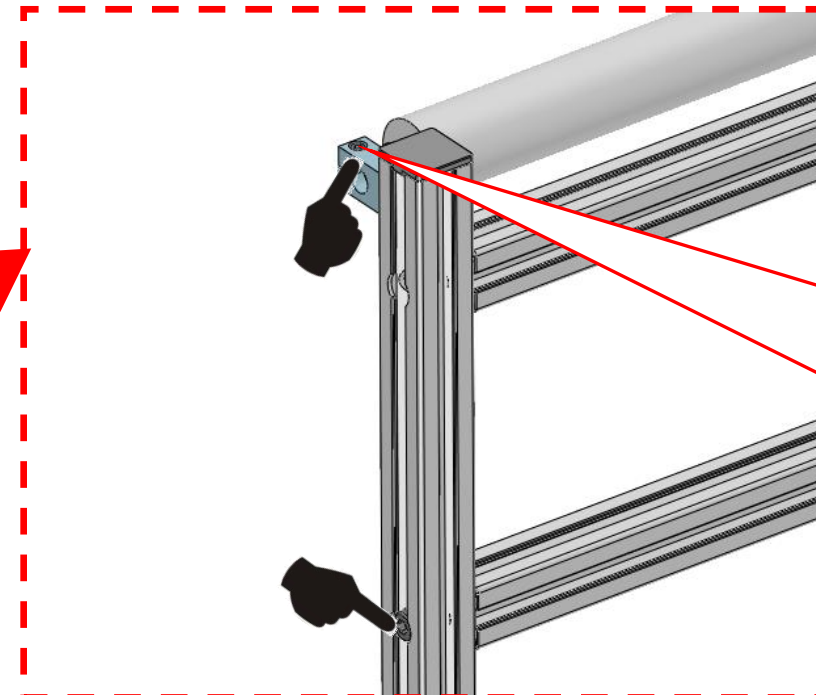
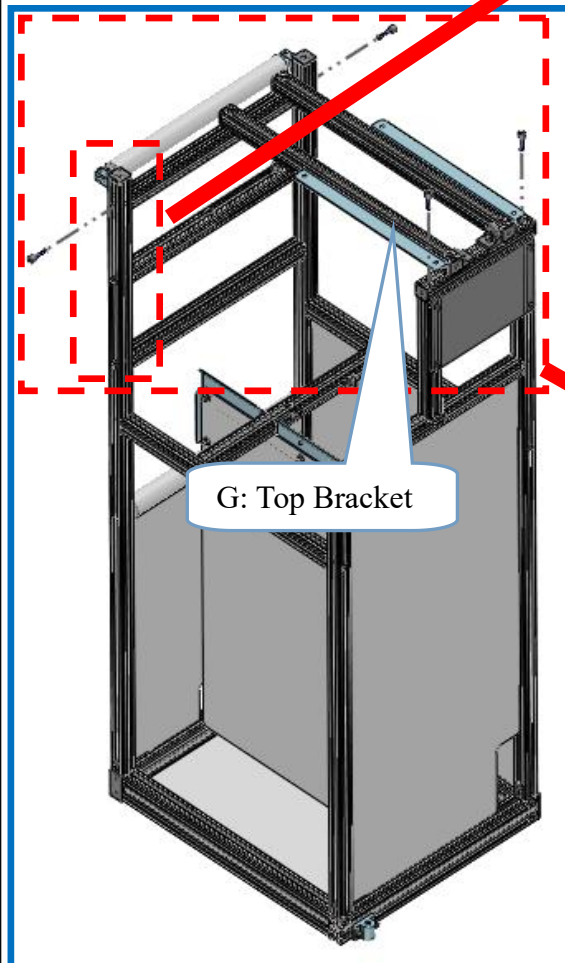
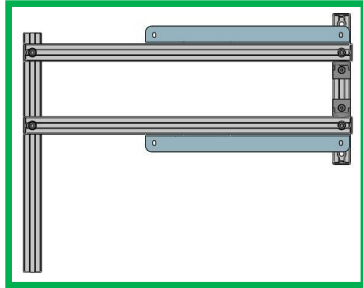

When installing the top bracket, loosen but do not remove the screws indicated by the fingers on the both sides.
Then tighten these four screws after installing the top bracket.

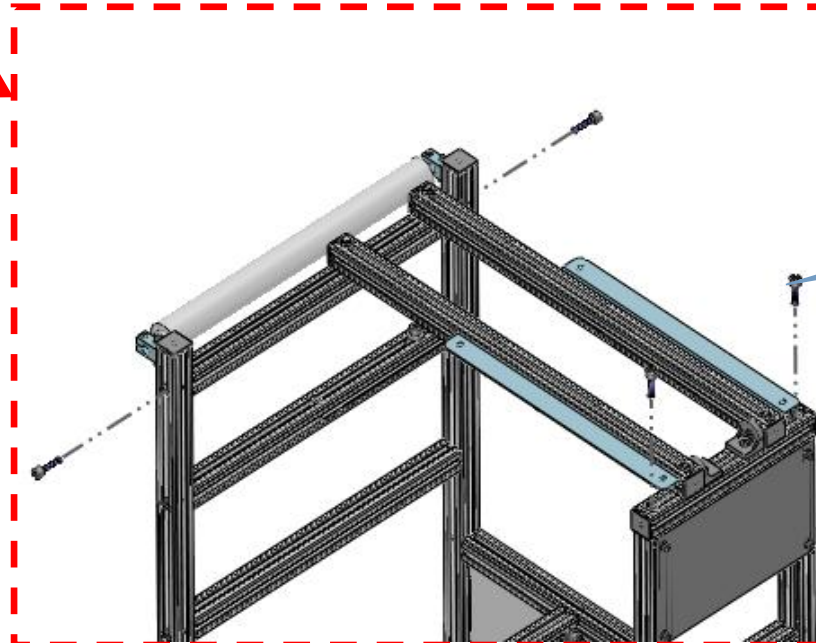

4 - Screw M8×35



Allen wrench M8

Operation Contents:

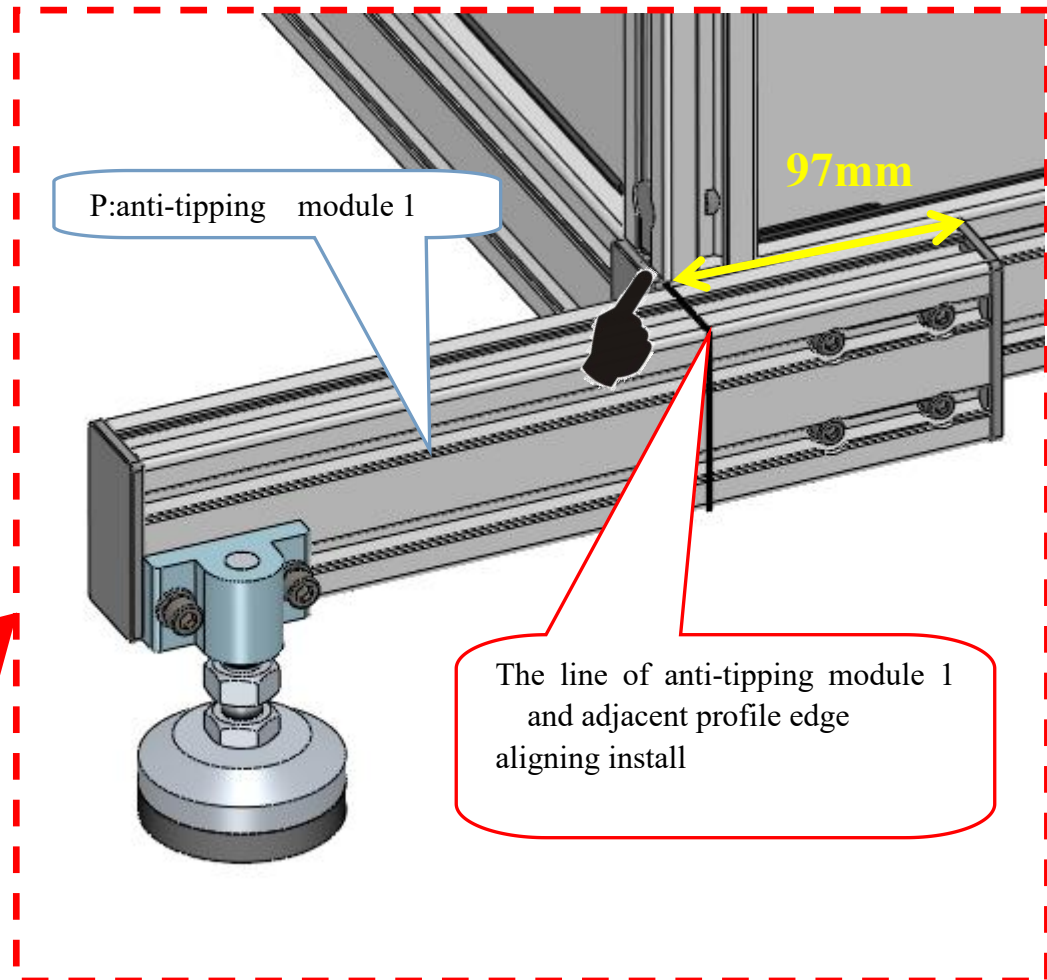
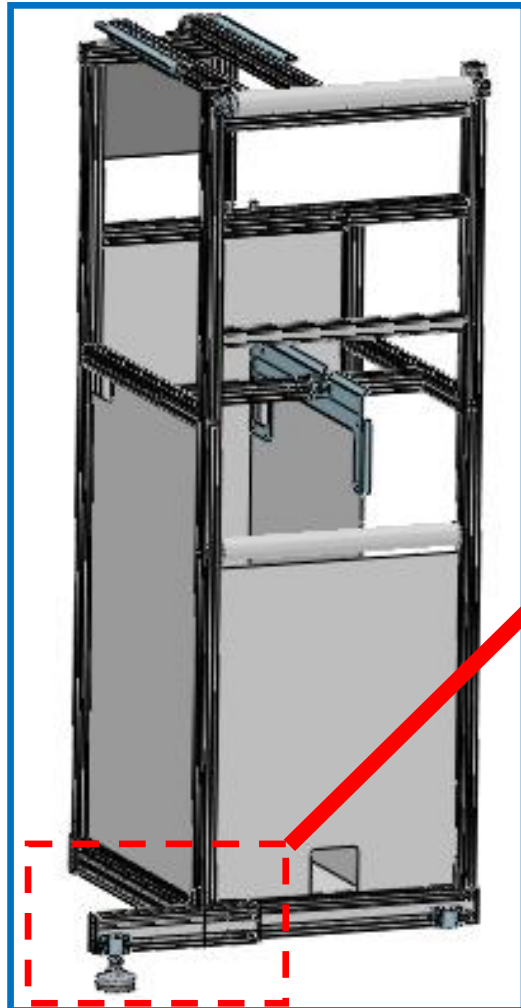
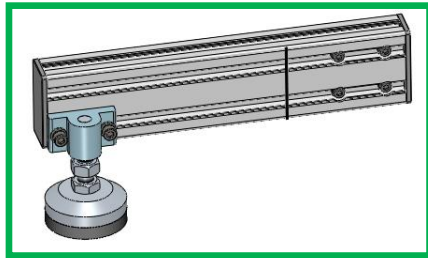

Operation Contents:

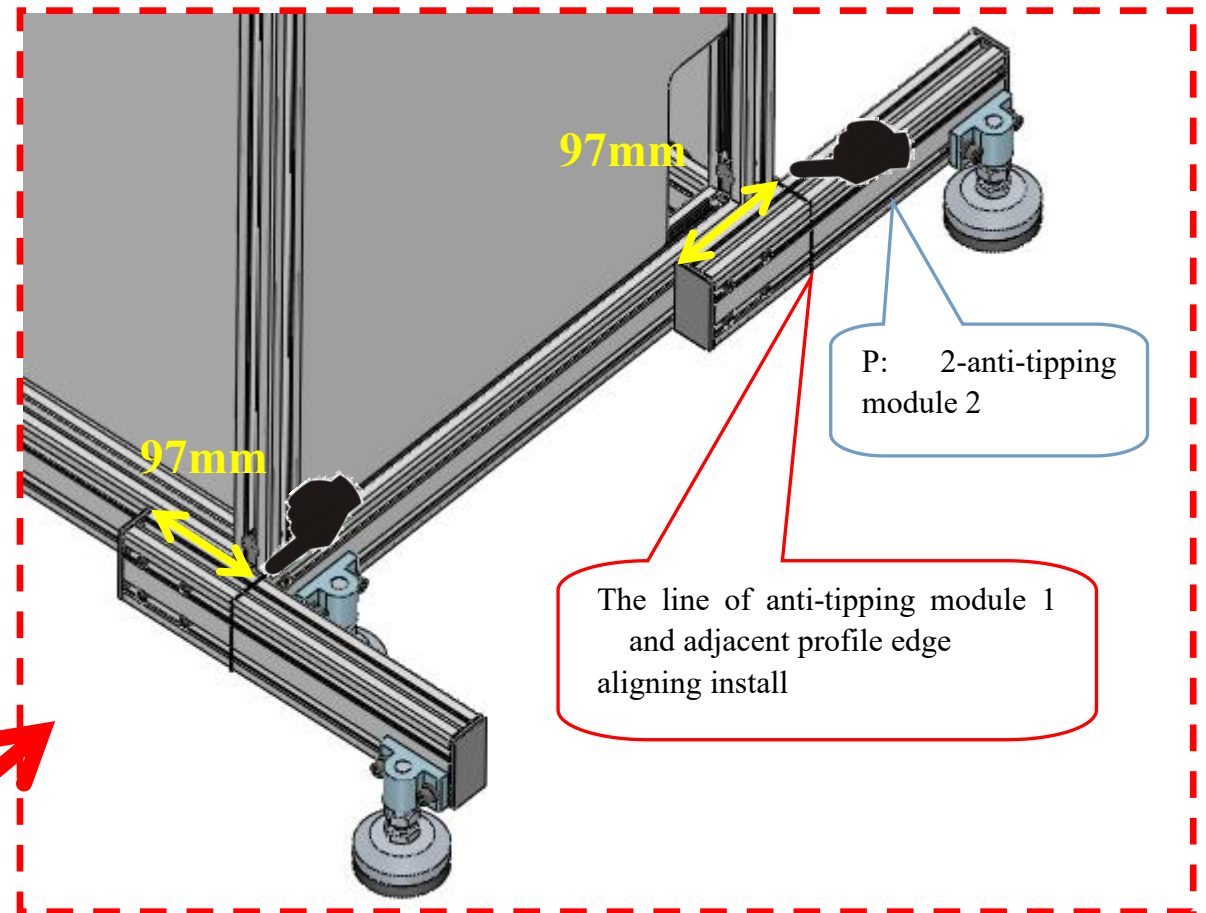
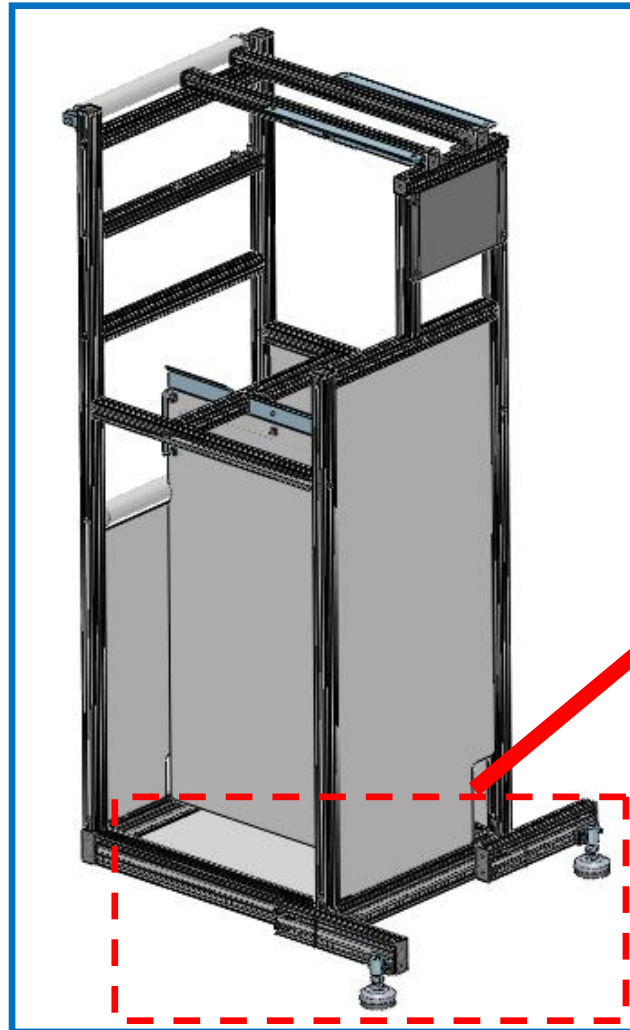
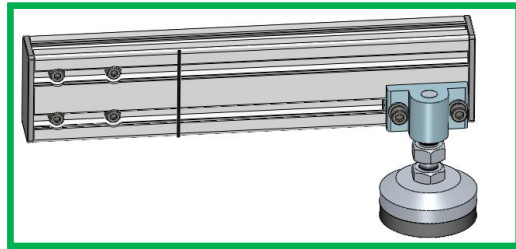

Operation Contents:

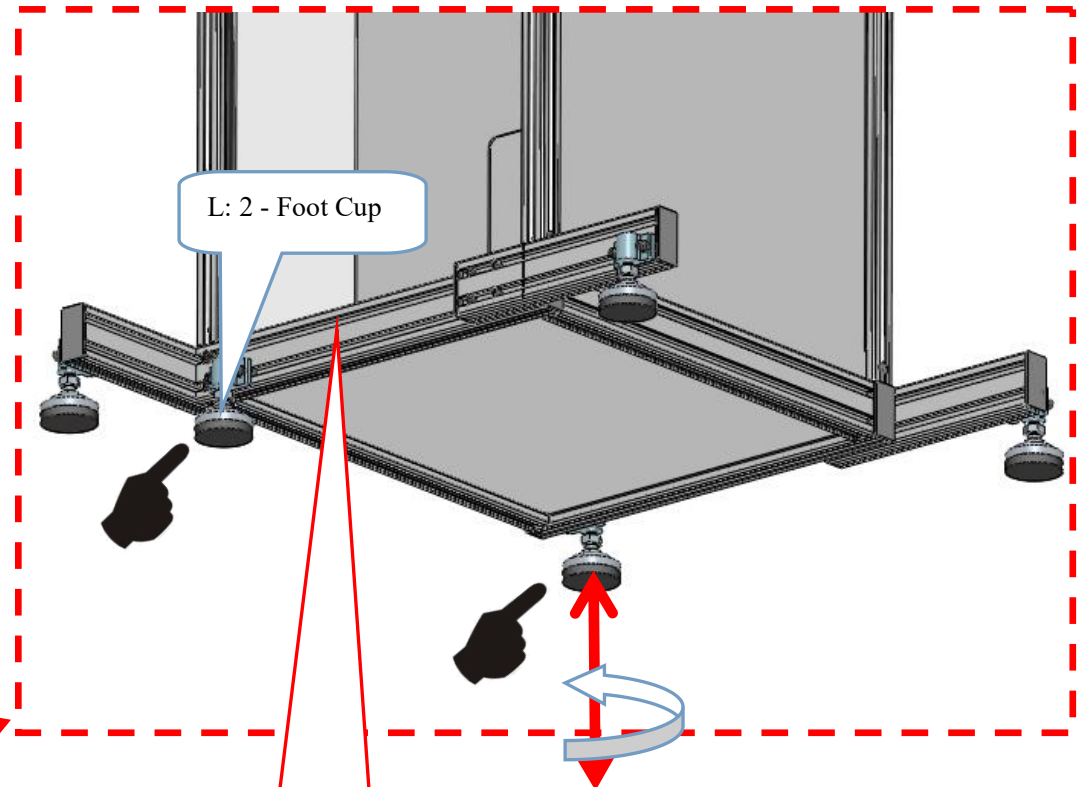
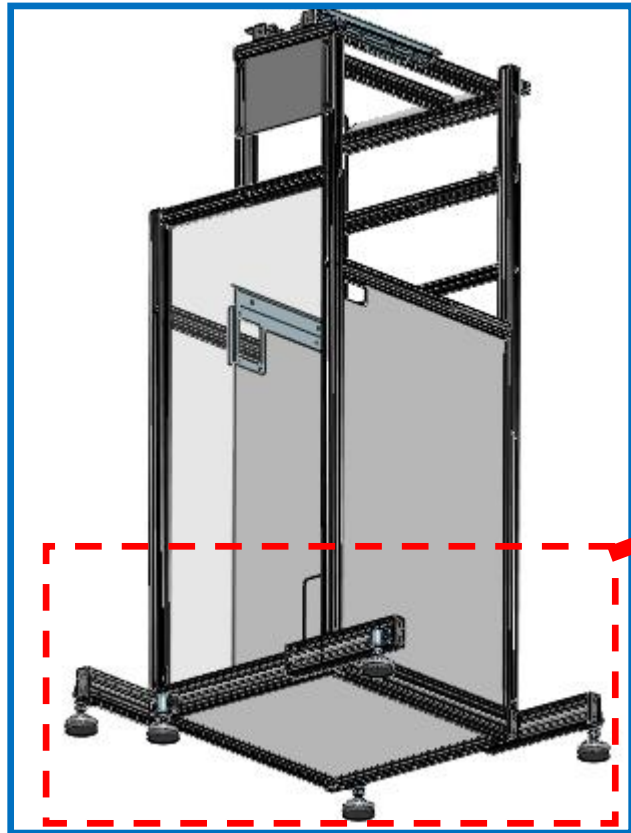

Level the support after the
foot cup is installed



Operation Contents:

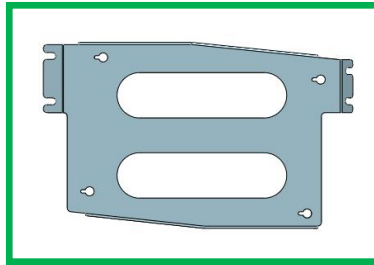

H: Machine Base

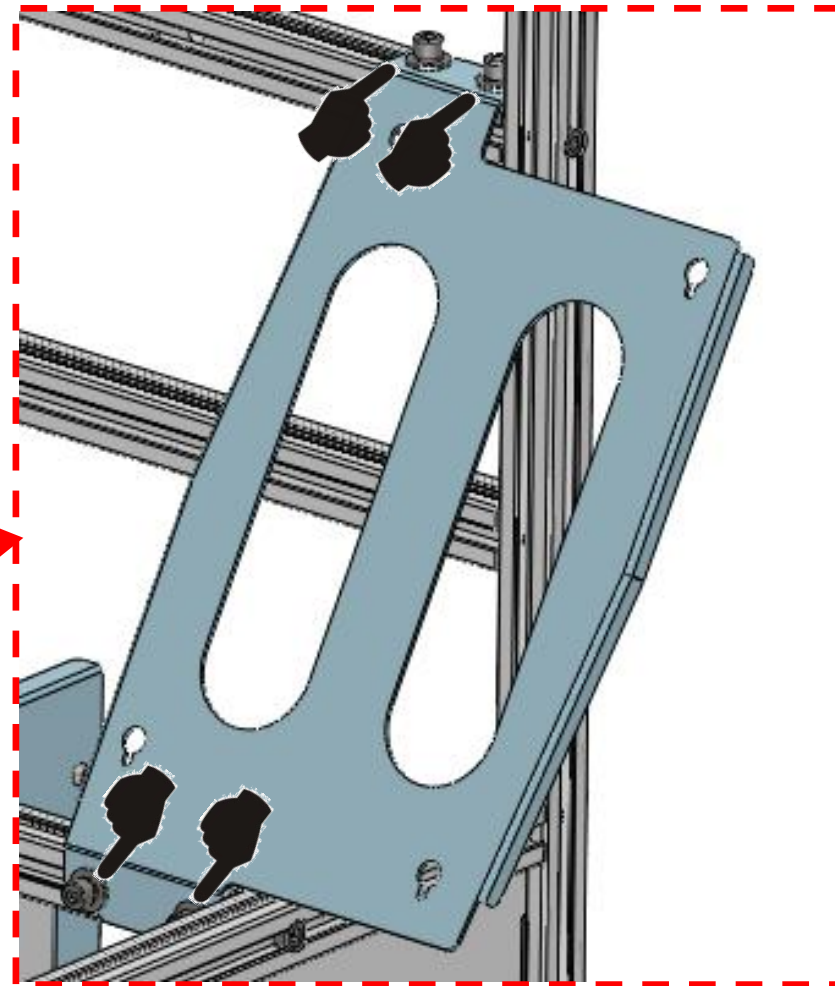
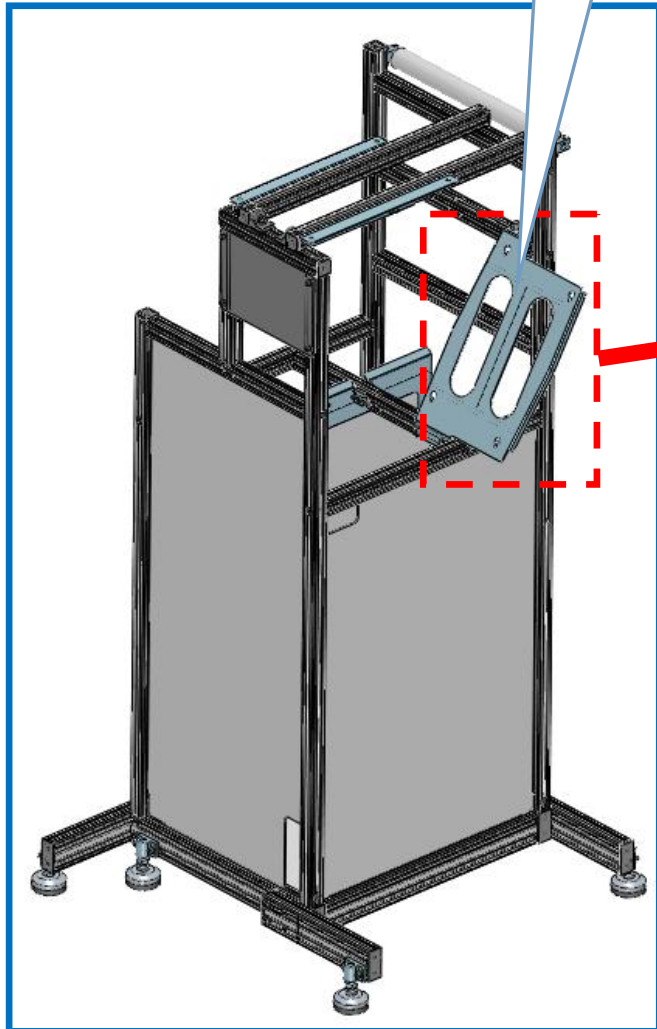

Allen wrench M8

Operation Contents:

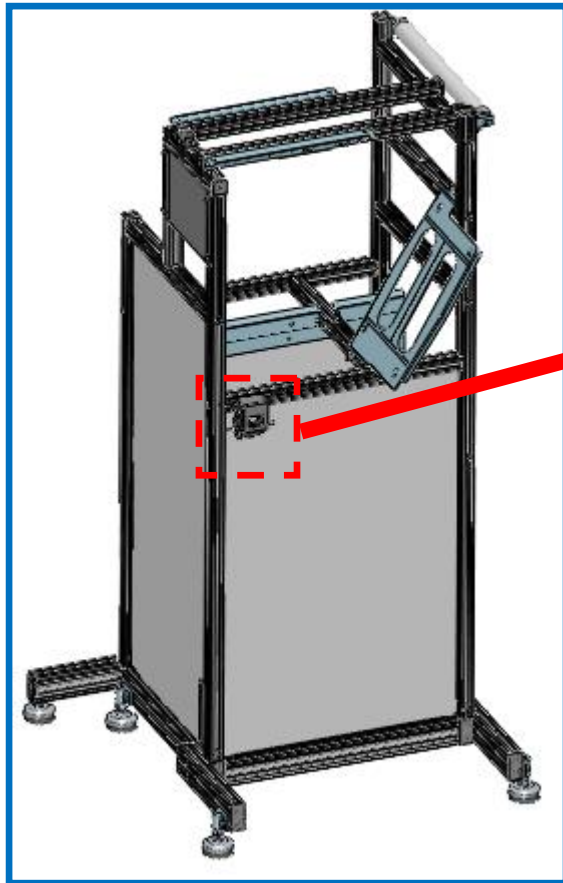
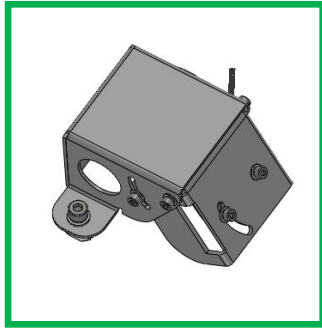

Allen wrench M5

Operation Contents:

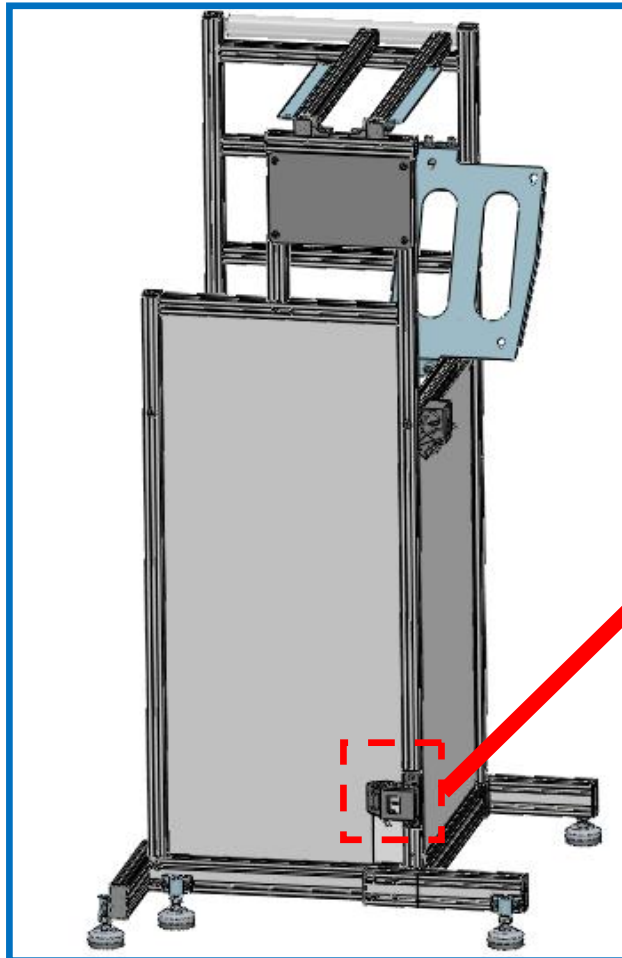
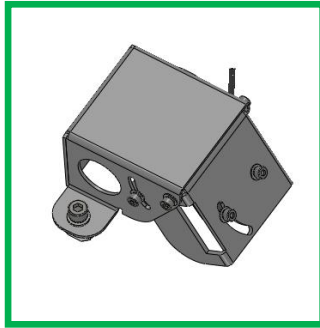

J: Low - Sensor component
- Transmitter end

The low sensor component
is installed and fixed in the
black line position

73mm

Allen wrench M5

Operation Contents:

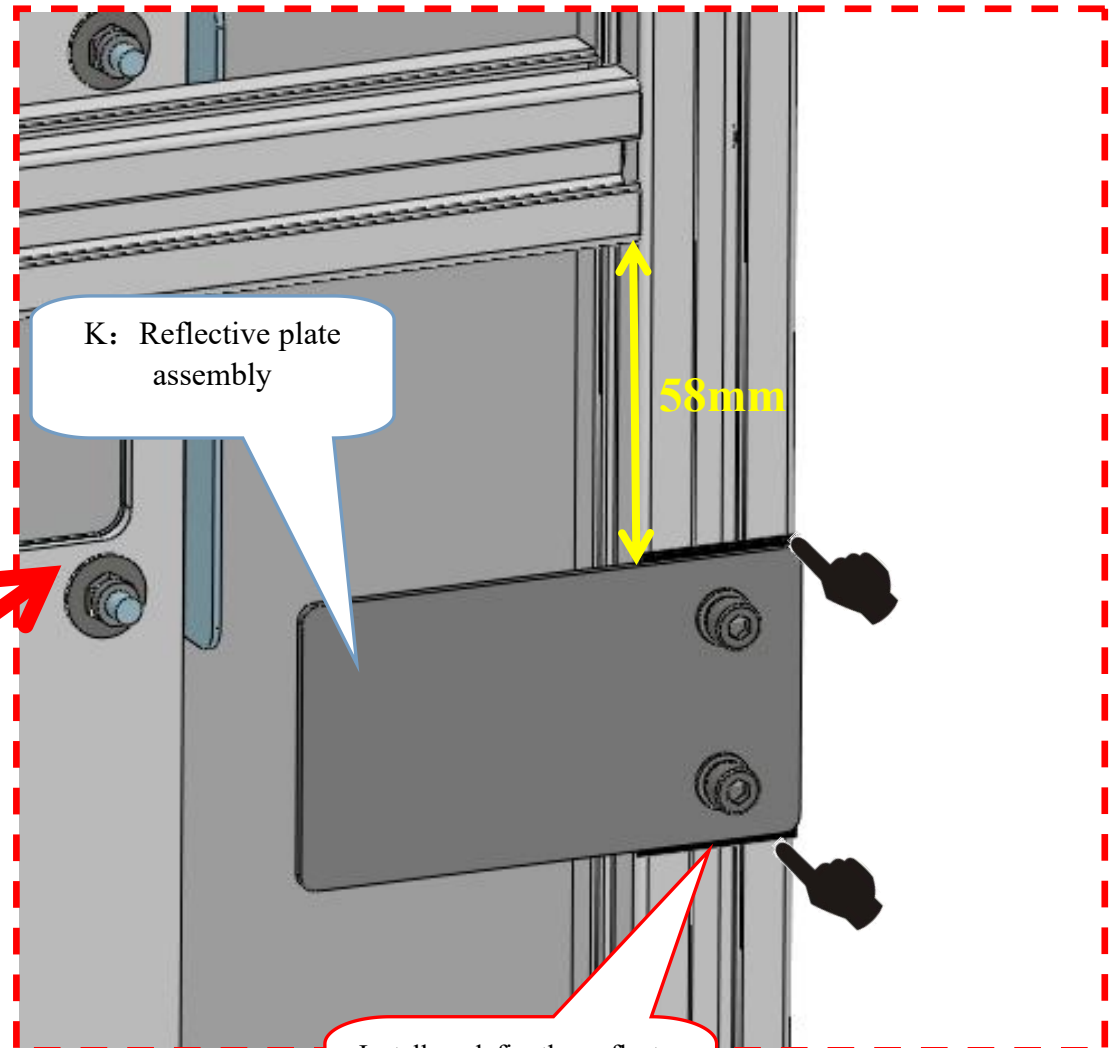
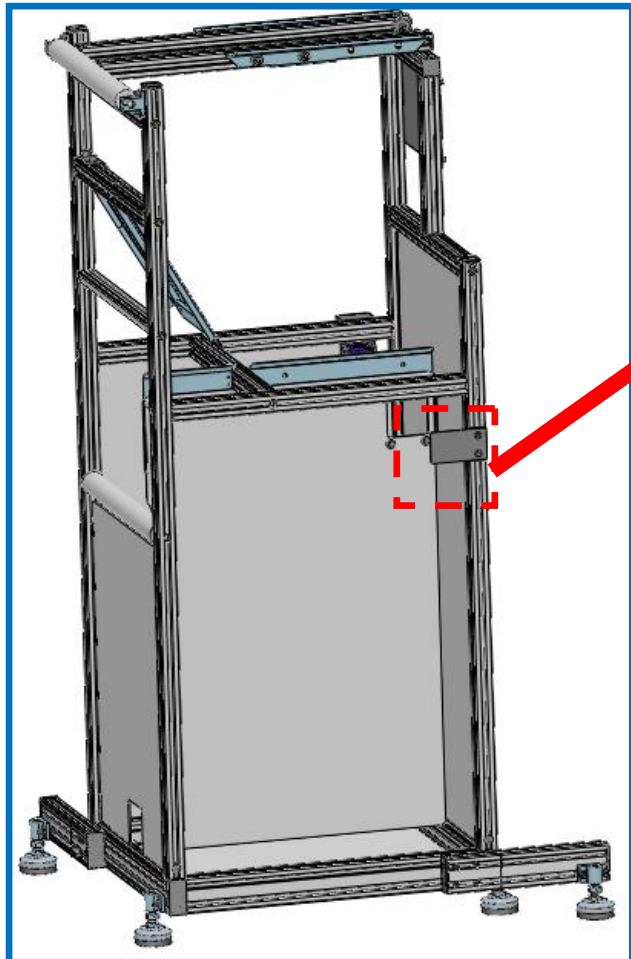
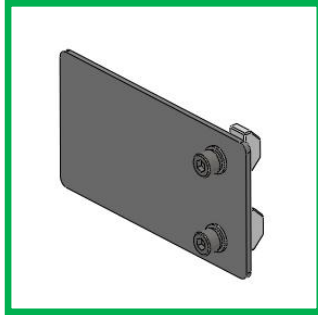

K: Reflective plate assembly

58mm

Install and fix the reflector components according to the black lines



Allen wrench M5

Operation Contents:

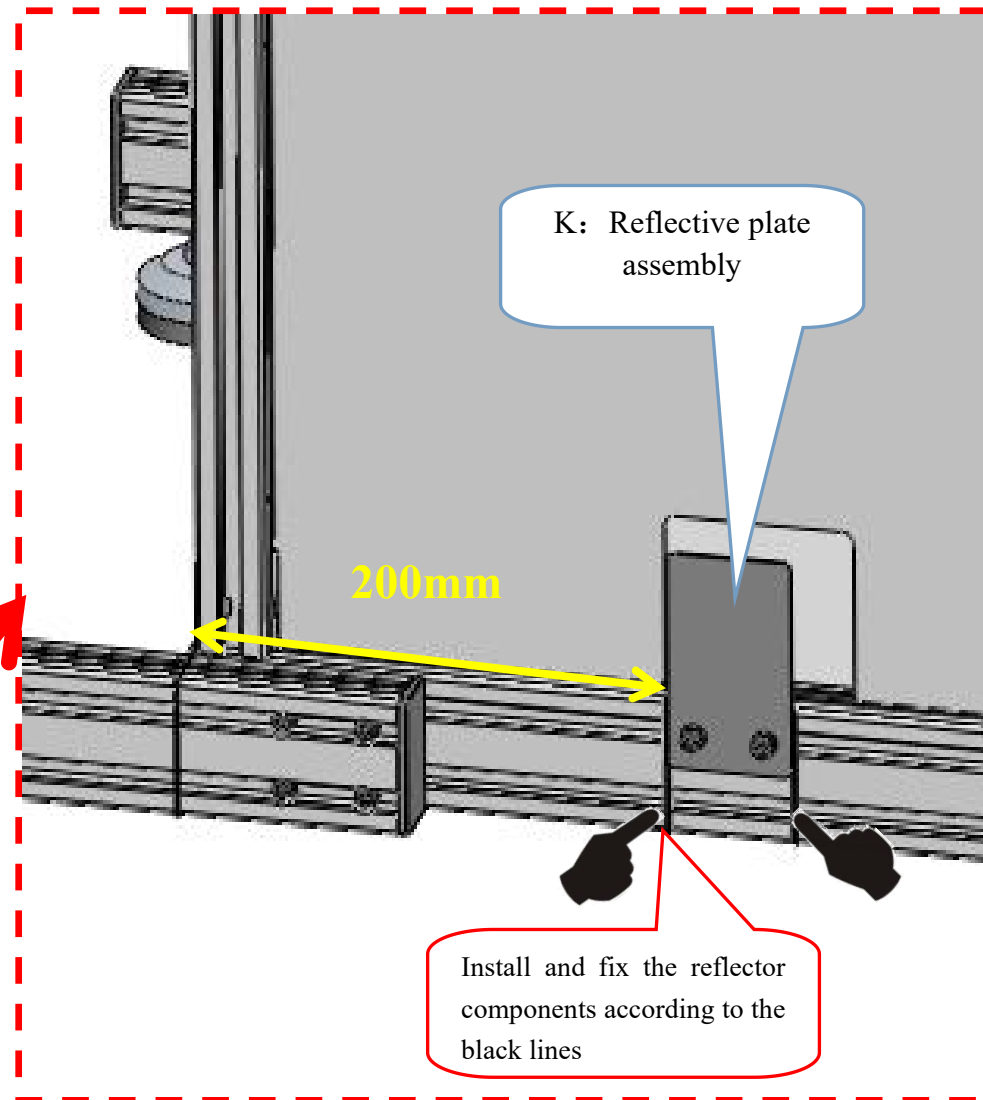
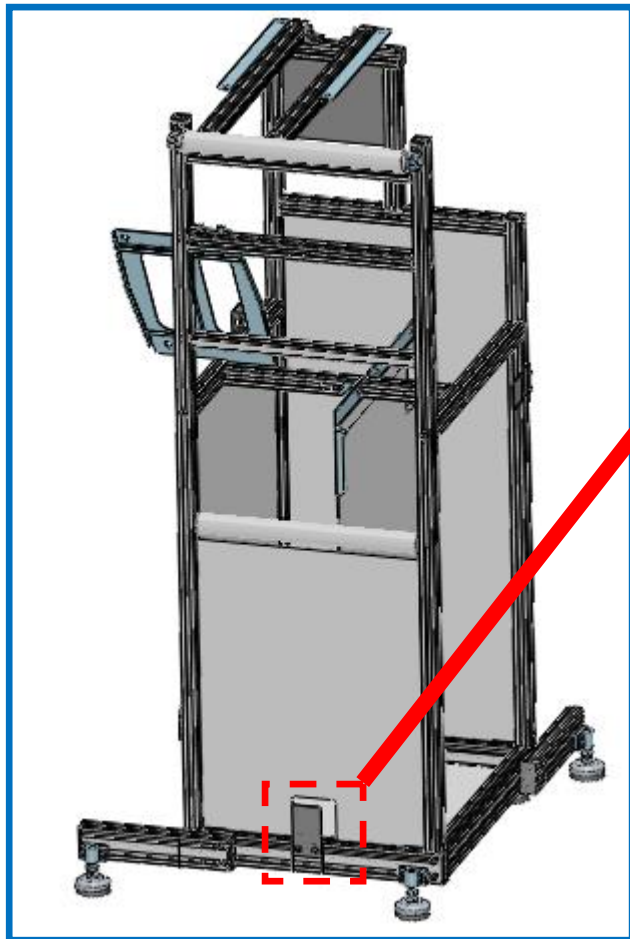
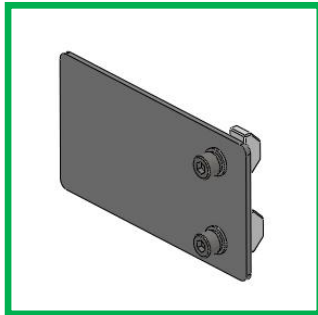

Operation Contents:

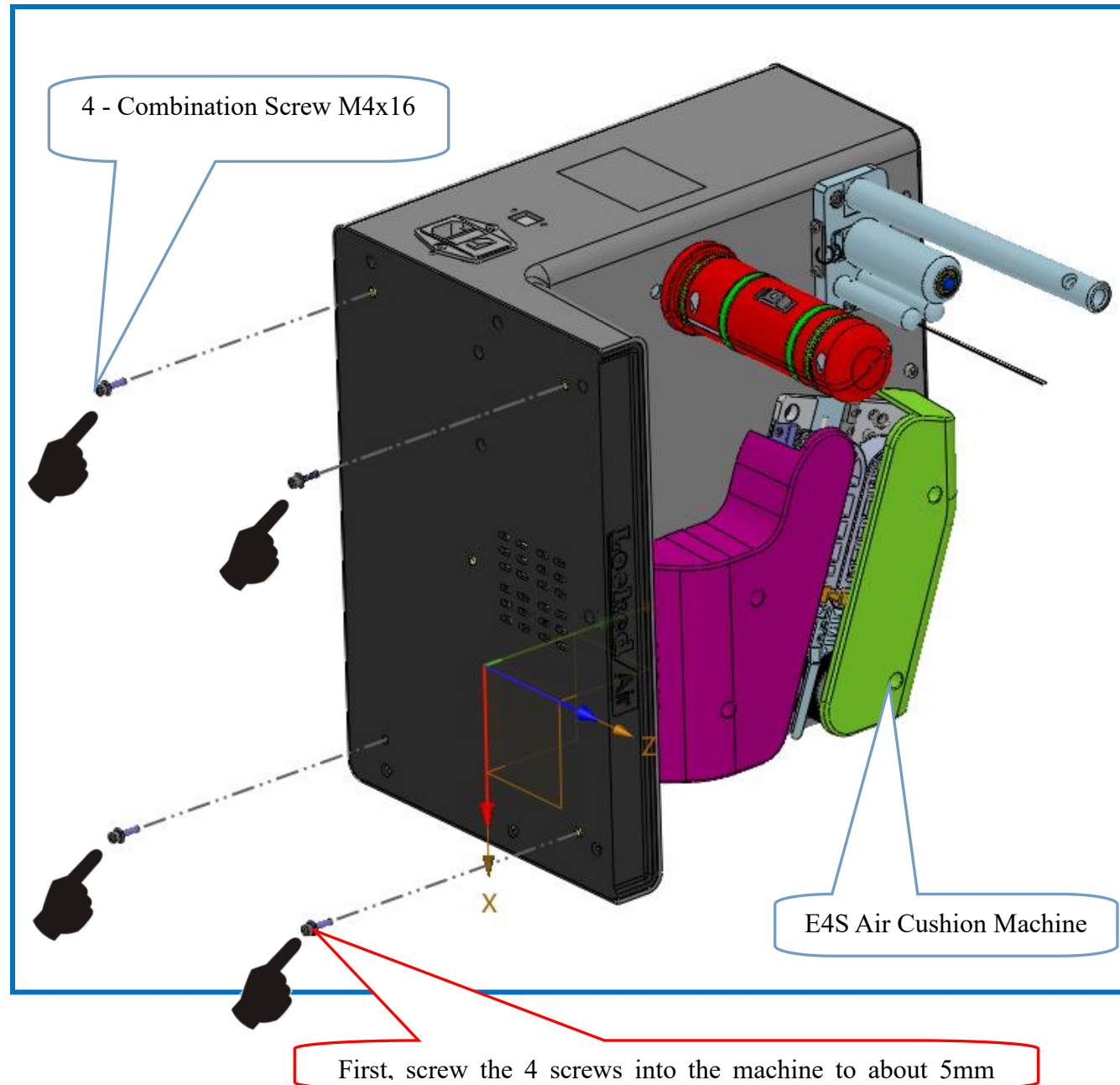

Operation Contents:

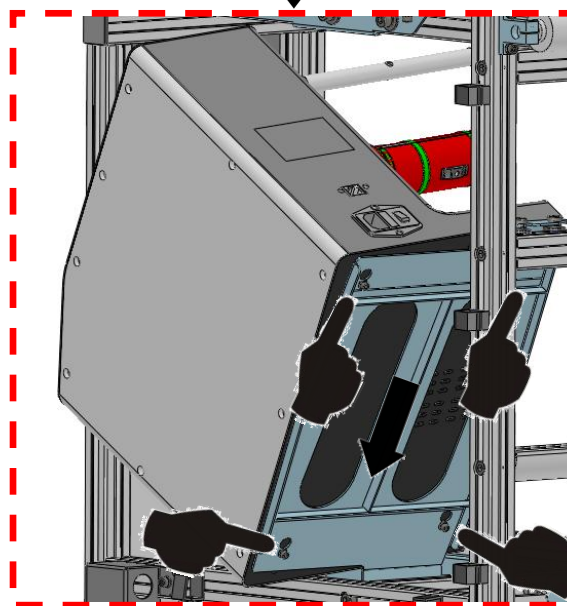
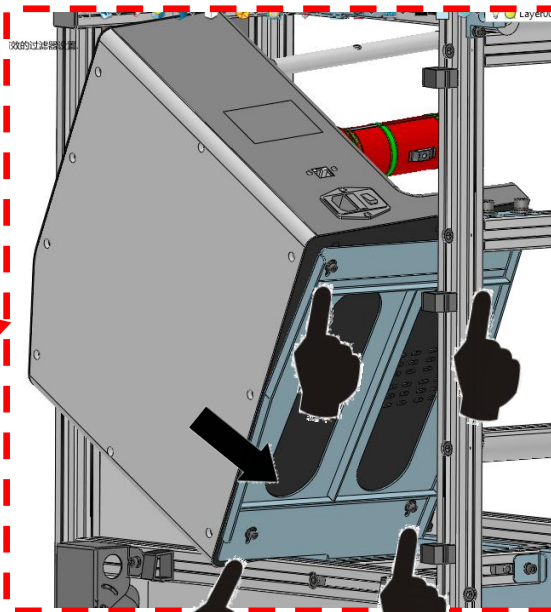
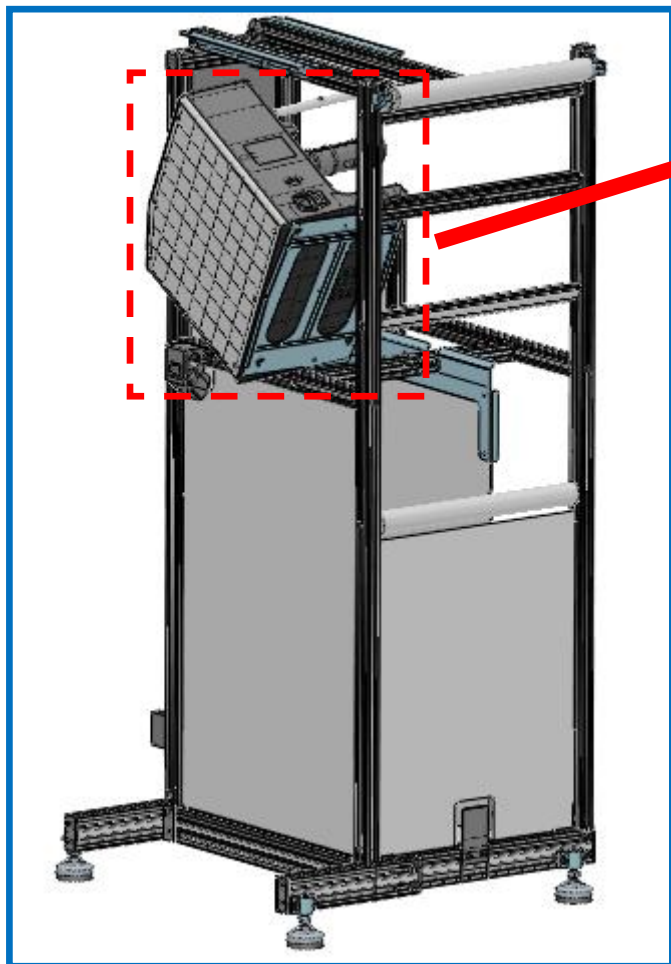

Operation Contents:

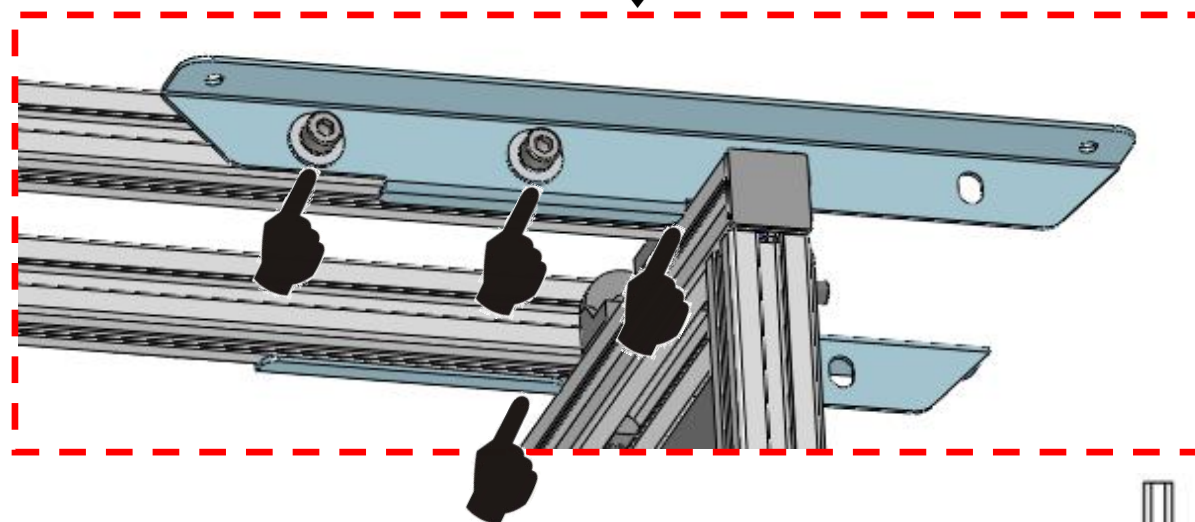
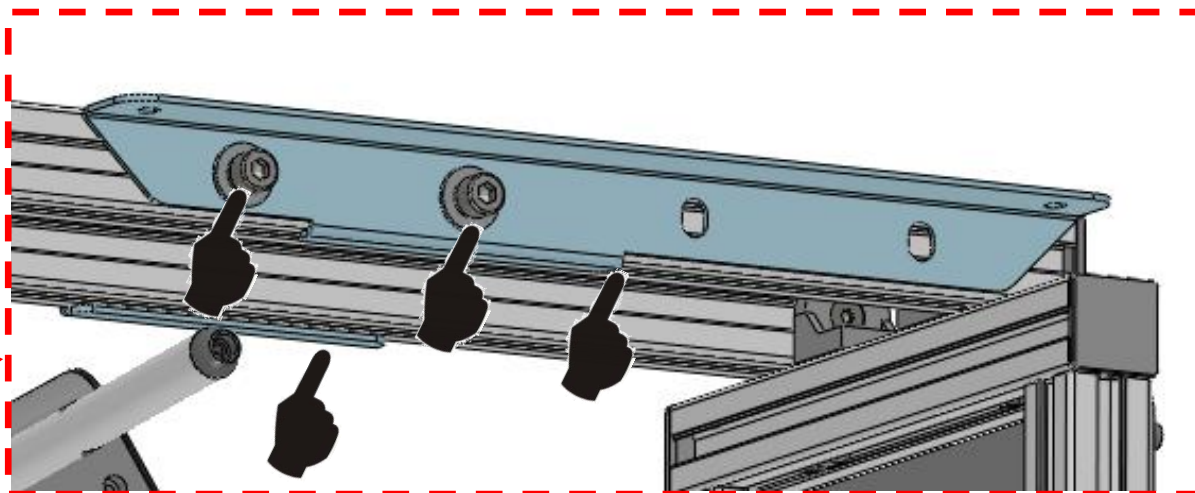
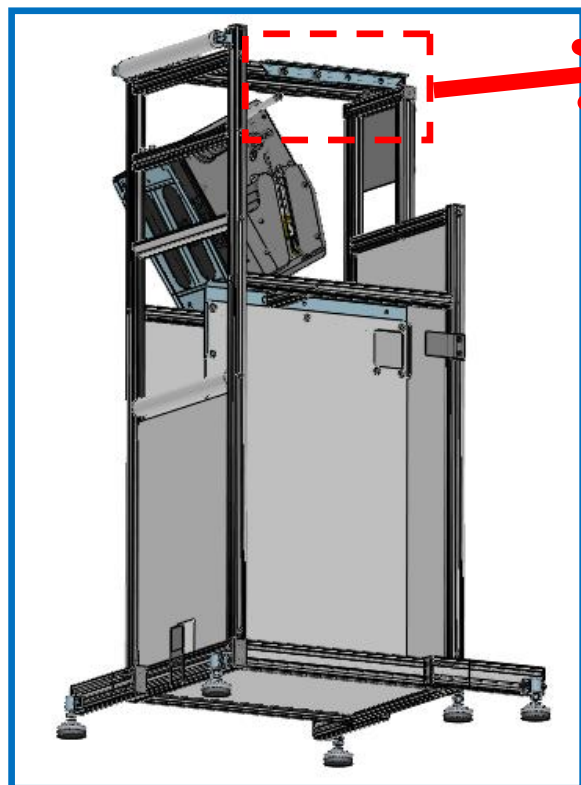

Allen wrench M8

Operation Contents:

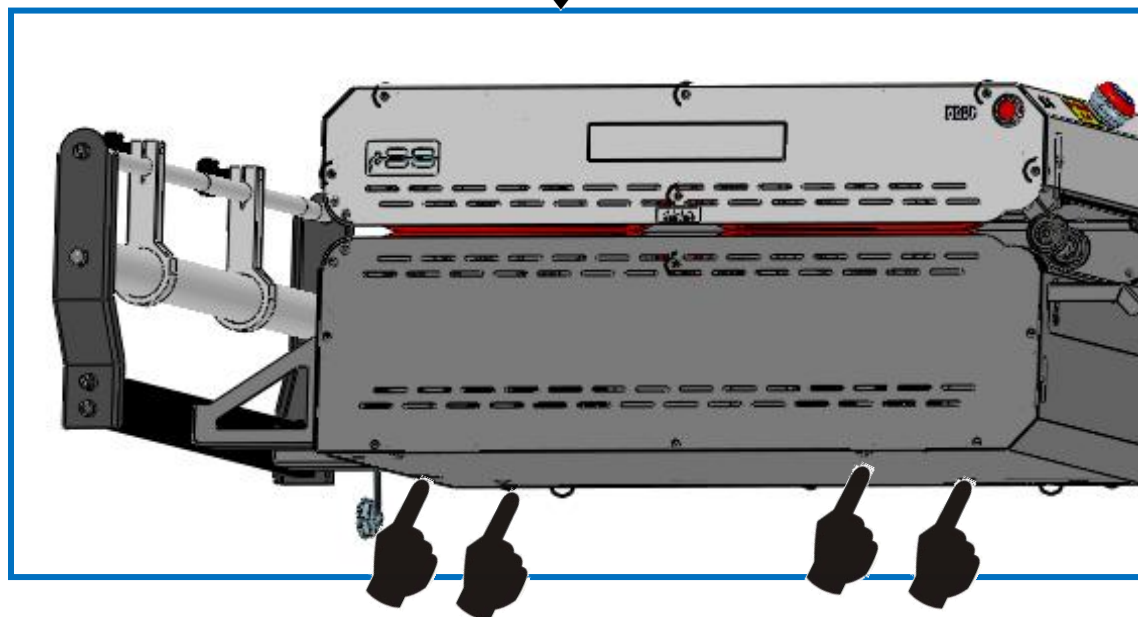
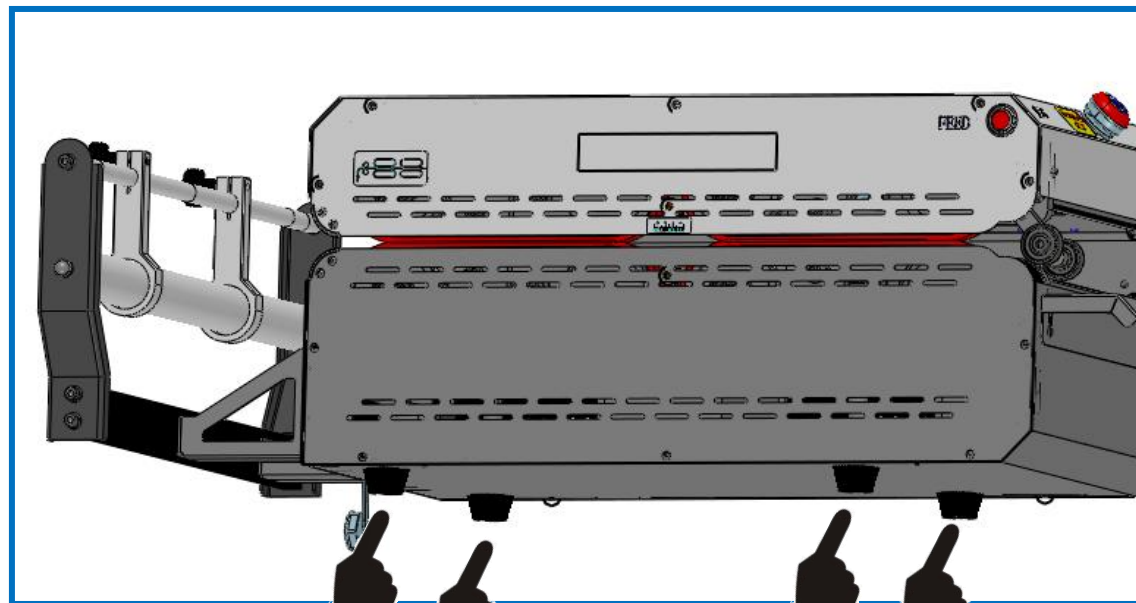

Operation Contents:

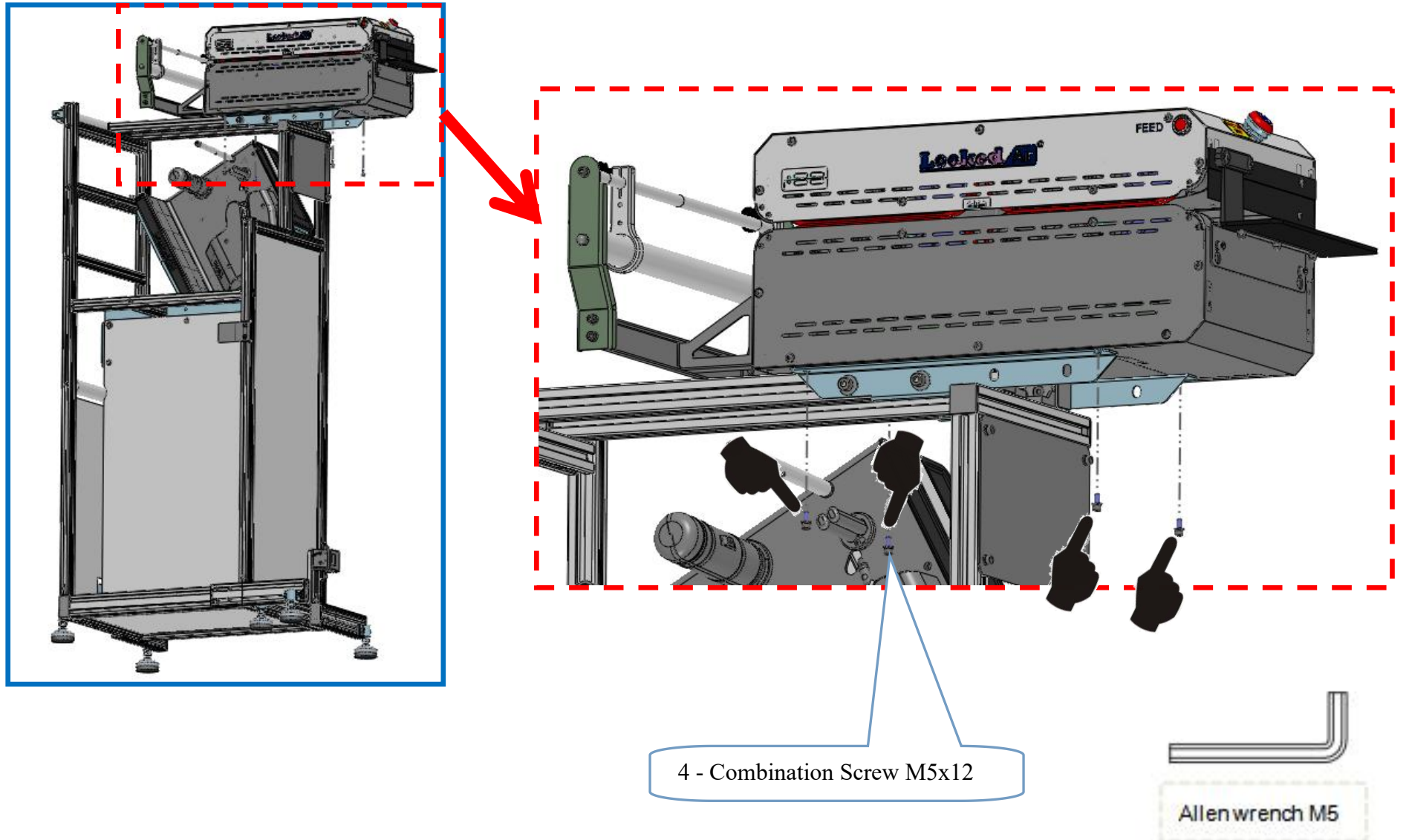

Operation Contents:

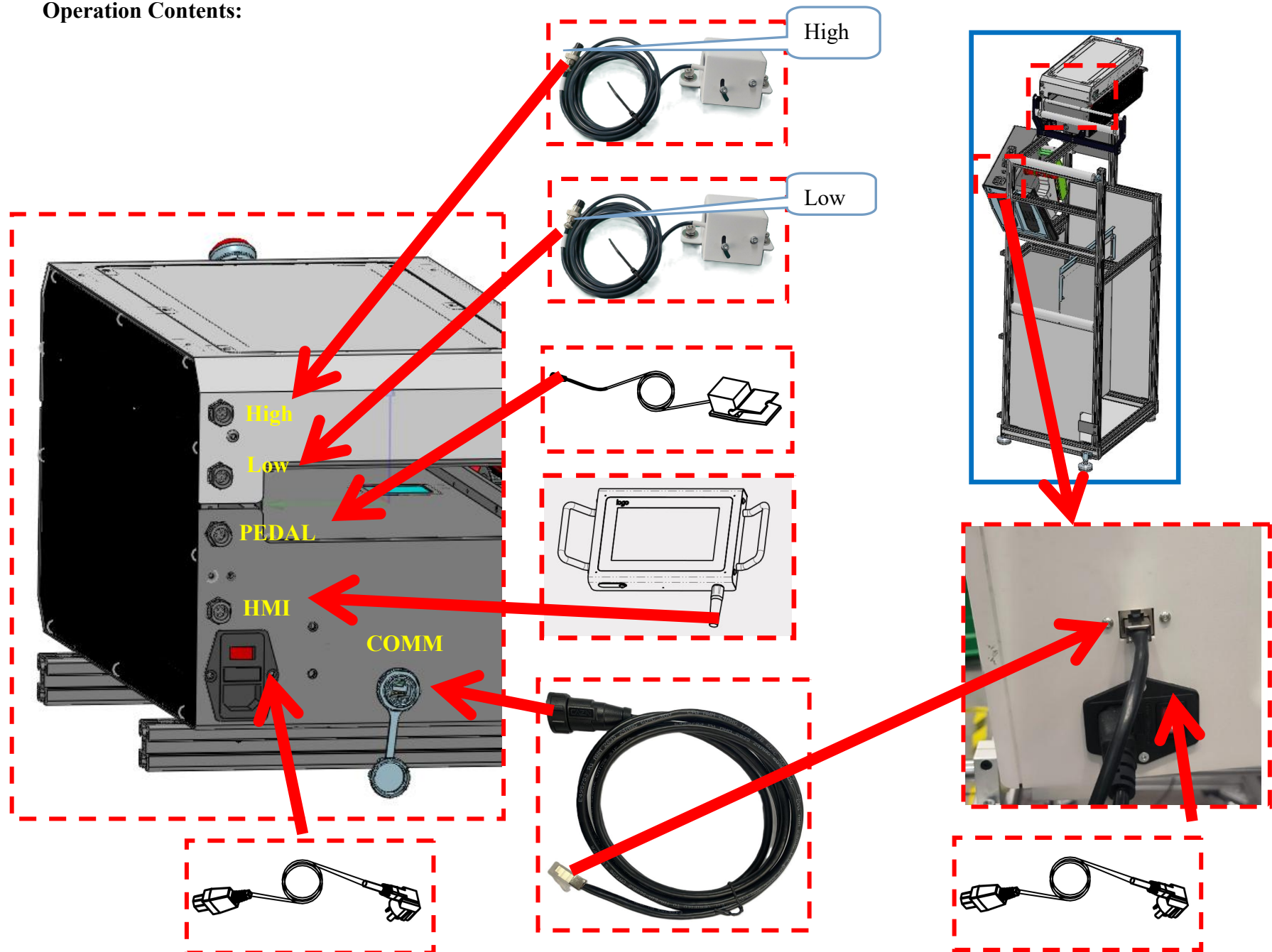

Power up to test the sensor function:

1. The light path of the sensor is unobstructed.

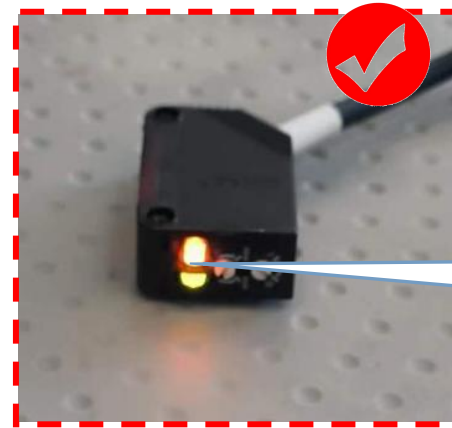
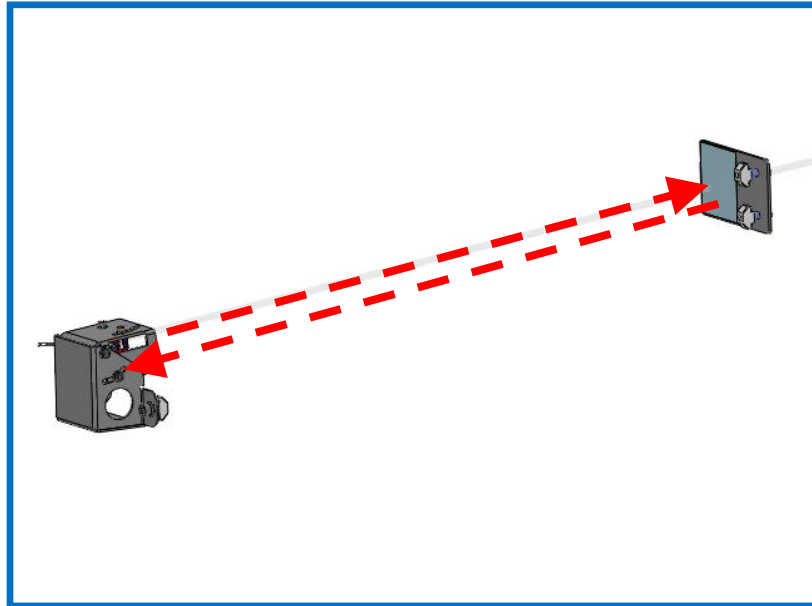

Both the green and the red light

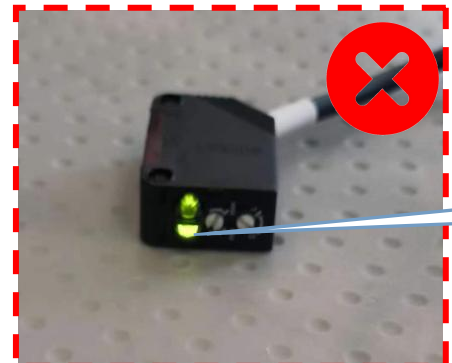

Only the green light



Both the green and the red are not bright, check whether the aviation plug falls of

Power up to test the sensor function:

2. Cover the reflective plate by hand.
3. After passing the sensor test, the installation of the bracket is finished.

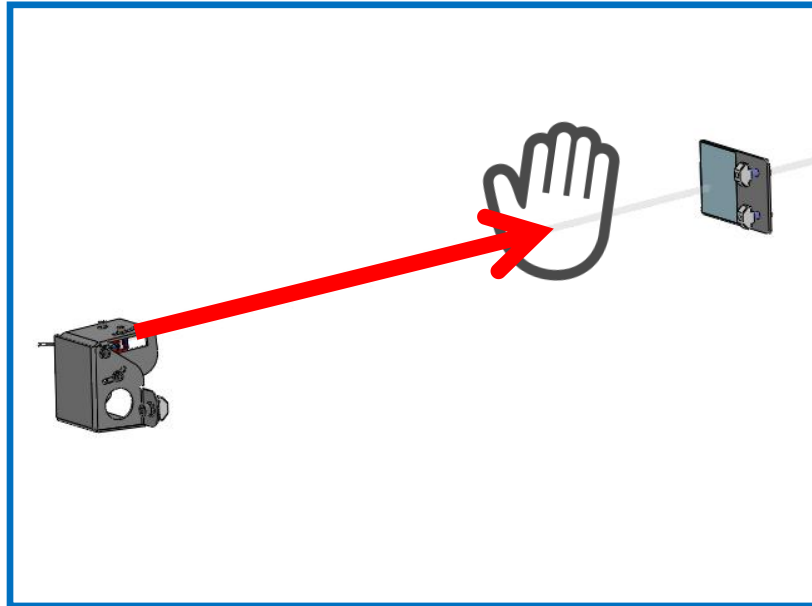

Only the green light



Both the green and the red light



Both the green and the red are not bright, check whether the aviation plug falls of

