



LP-HA V2.5

User Manual of automatic honeycomb paper dispenser



Hangzhou Bing Jia Tech. Co., Ltd

Tel:+86 571 86169196

Email:info@lockedair.com

7F,11th Building, West Area, Chinese Artificial Intelligence
Town(CAIT),Hangzhou 311121,Zhejiang ,P.R.China

Content

| | |
|---|-----|
| PREFACE | I |
| Disclaimer | I |
| SAFETY | II |
| Operators | II |
| Service technicians | II |
| Rules of Safety | II |
| Warnings | III |
| Improper Use | IV |
| 1. Brief introduction | 1 |
| 1.1 Spare part of automatic honeycomb dispenser | 1 |
| 1.2 Panel | 2 |
| 2. Installation and Usage of Machine | 4 |
| 2.1 Installation | 4 |
| 2.2 Power connection | 4 |
| 2.3 How to feed | 5 |
| 2.4 Setting and Instruction | 6 |
| 3. Error code and exclusions | 7 |
| 4. Specification | 8 |
| 4.1 Basic specification | 8 |
| 4.2 Material Specification | 8 |
| 5. Transport and Storage | 9 |
| 5.1 Transport | 9 |
| 5.2 Storage | 9 |
| 6. Maintenance and Repair | 10 |
| 6.1 Maintenance | 10 |
| 6.2 Repair / Replacing Parts | 10 |
| 7. Appendix | 11 |
| 7.1 Dimension drawing of machine assembly | 11 |

PREFACE

Thank you for using the Locked Wave automatic honeycomb dispenser. Please read this manual before you operate to ensure that you use the device correctly!

Tip: The operation of different models is slightly different, please pay attention to the instructions in the tips of the manual.

Tip: The operation of different models of machines is slightly different, please pay attention to the tips in the text of the manual.

Disclaimer

The manufacturer and its authorized distributor are not liable for any accidents or damages resulting from the failure to comply with warnings or instructions depicted on this converter or contained in this operator manual, including:

- Improper use or maintenance
- Use for applications or under conditions other than those outlined in this operator manual
- Use of unauthorized parts
- Repairs or modifications made without the permission of the manufacturer
- Unauthorized alterations to the converter such as:
 - a) Alterations to the control system
 - b) Welding, mechanical treatments etc.
 - c) Extensions to the converter or the control system

The manufacturer and its authorized distributor are not liable for:

- Indirect damages caused by errors or malfunctions of the converter (e.g. damages to products, company interruptions, delays, etc.).

SAFETY

This converter has been designed for safe use in conformance with the application, conditions and rules described in this operator manual. Anyone that works with or on this converter must read the operator manual and follow the instructions carefully

Operators

Only those who read and understand the Sections “Safety” and “Operator Instructions” should operate the converter. Special training is not required.

Operator tasks include:

- Operating the converter
- Regular maintenance (see section 6.1)
 - Remove paper scraps
 - Remove excessive paper dust

Service technicians

Only service technicians employed by Lockedpaper or a Lockedpaper distributor are permitted to conduct service on the converter. For these individuals, a separate service manual is available.

Rules of Safety

- a. The power supply must be consistent with the parameters on the machine label, it is strictly prohibited for wrong connection, please only use the power cord provided with the product in order to prevent damage to the machine;
- b. Please ensure that the power supply is reliably grounded
- c. Pay attention to the occurrence of short circuits, breaks of the internal wiring of the safety switch during moving and carrying

- d. Safety devices are not allowed to be switched off or removed
- e. Do not remove or cover warning labels
- f. Keep the working area clean and free of obstacles
- g. Unplug converter and gather all loose cords before moving the converter
- h. Pay attention when using hand tools such as knives, scissors etc, due to the risk of cutting
- i. Ensure that:
 - cords cannot be damaged
 - the working area is sufficiently lit
 - the working area is sufficiently ventilated

Warnings

- a. Do not touch any rotating parts while the machine is working;
- b. Non-professionals are prohibited from opening the top cover and the right side cover for maintenance;
- c. It is strictly forbidden to touch the cutter when maintaining equipment;



- d. It is strictly forbidden to touch the gears and rubber rollers when maintaining equipment;



- e. Press the emergency stop switch to cut off the total power supply of the machine with the following case:

- There is jam in the inlet

- Abnormal sound generated inside the machine
- Other abnormal condition

Improper Use

The following applications or acts are not suitable for the converter, and constitute improper use of the converter:

- Use of materials other than those produced by Lockedpaper and intended for use in the converter
- Use outside or in a humid area
- Use in areas subject to an explosion hazard
- Washing or cleaning the converter with excessive quantities of water
- Standing on the converter
- Placing objects against or on top of the converter
- Moving the converter while it is functioning or connected to the AC power supply.

1. Brief introduction

Automatic honeycomb paper dispenser is a machine which can change die-cut kraft paper into a 3D honeycomb structure wrapping paper, no tape bonding, can meet most of the packaging needs, transform into cushioning, shock absorbers. Compared to traditional buffering and packaging materials, the 3D stereoscopic cellular structure wrapping paper of electric honeycomb paper dispenser can protect the fragile items more effectively such as glass and ceramics from different angles, thus adapting to different packaging applications.

Honeycomb paper dispenser with a cutting device is an electric device. The functional system consists of a roll support frame, a die-cut kraft paper expansion device and a cutter. In the paper dispenser, die-cut kraft paper is stretched to form a three-dimensional Lockedpaper™ buffer packaging material.

1.1 Spare part of automatic honeycomb dispenser

Support rod: to hold and fix the roll paper;

Paper dispenser: stretch the die-cut kraft paper to form a three-dimensional cellular structure wrapping paper;

Cutter: hold the die cutter and cut off the honeycomb paper;

Foot pedal: to start and stop the honeycomb dispenser;

1.2 Panel

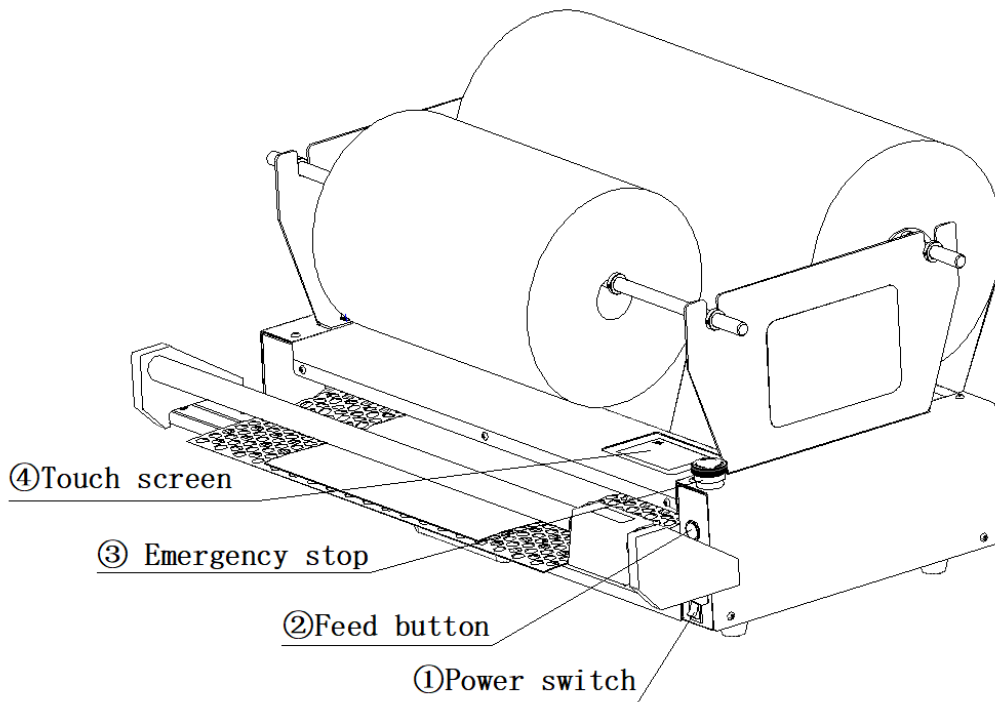

Operation interface

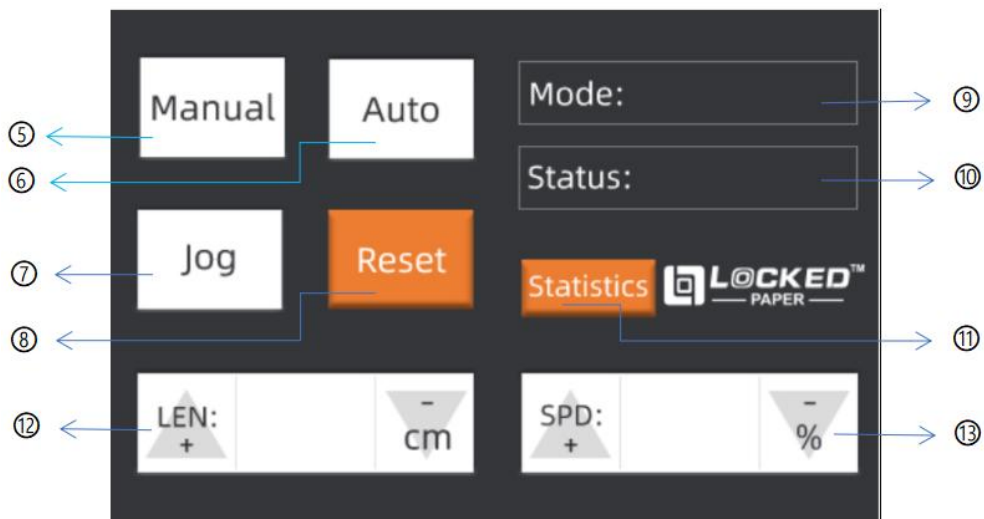

- ① Power switch: To power on/off the machine;
- ② Feed button: To feed the paper into the machine;
- ③ Emergency stop: For error or dangerous case;
- ④ Touch screen: To display working mode, working parameters, and error codes;
- ⑤ Manual button: Normal mode;

- ⑥ Auto button: Automatic mode;
- ⑦ Jog button: Feeding mode;
- ⑧ Reset button: Reset the status of the machine;
- ⑨ Mode: To display the working mode;
- ⑩ Status: Showing error;
- ⑪ Statistics: Statistical Functions;
- ⑫ LEN: To adjust the length;
- ⑬ SPD: To adjust the speed;

Statistical Functions interface

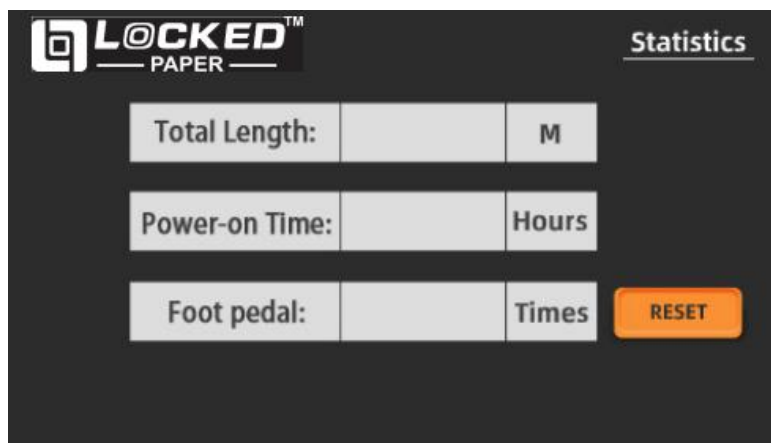

2. Installation and Usage of Machine

2.1 Installation

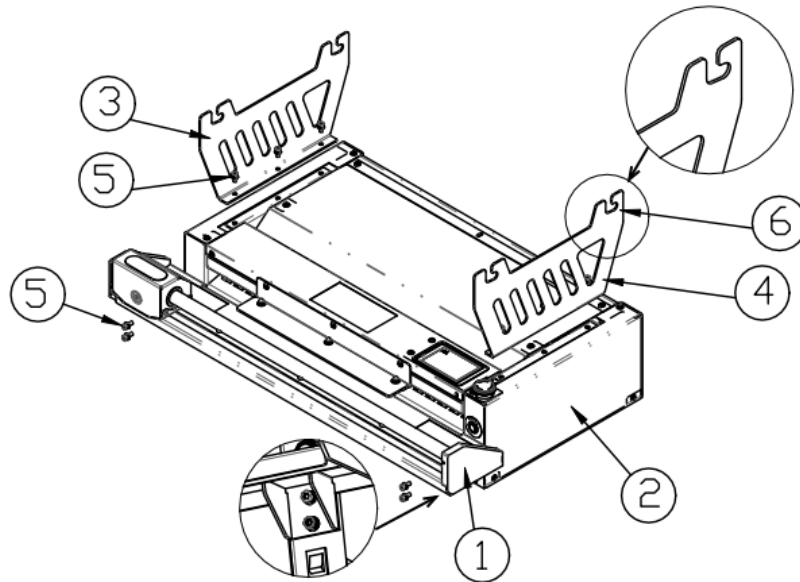

| Serial number | Name | Quantity |
|---------------|-----------------------------------|----------|
| ① | Cutter | 1 |
| ② | Paper dispenser | 1 |
| ③ | Left Plate | 1 |
| ④ | Right Plate | 1 |
| ⑤ | M5X10 hexagonal combination screw | 10 |

- 1、 Please put part ② on the desk;
- 2、 Fix ③ and ④ on ② by ⑤, Note that the notch direction should be backward (look at ⑥ in picture);
- 3、 fix ① on ② by ⑤

2.2 Power connection

Power : 200~240VAC/100~120VAC Detailed parameter is on the label of machine

2.3 How to feed

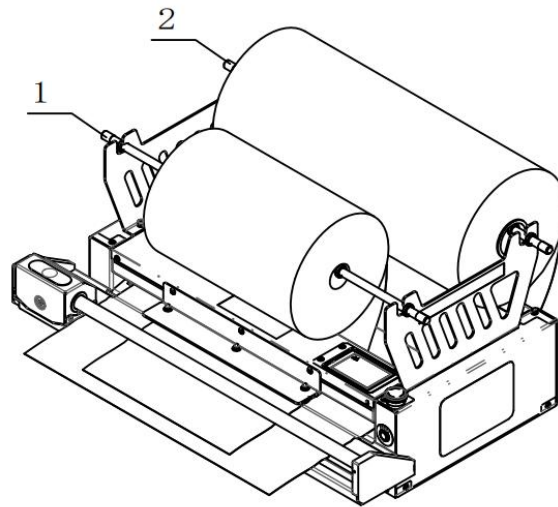

When the machine is first powered on or the alarm has been recovered, if the machine needs to be fed after determining that the roll is without paper, you can do the following:

- 1、 The MG tissue paper is into the support rod-1, die-cut kraft paper roll is into the support rod -2
- 2、 Lead the roll paper into the feeding inlet, press the Jog button (or feed button) and the wheel rotates at low speed until the honeycomb paper is exited and manually pressed Jog button (or feed button) to finish feeding

2.4 Setting and Instruction

| SN | Content | Detail |
|----|-----------------------|--|
| 1 | Enter setting status | Turn on the power switch and the setting is displayed on the touch screen to select according to your needs. |
| 2 | Switch working mode | Click on mode selection once the touch screen enters the main interface, Manual->Auto->Jog->Reset |
| 3 | Feeding mode | Press Jog button (or feeding button) |
| 4 | Adjust parameter | Length mode: Click LEN to enter the required length once you have entered the settings interface (in cm, ≥ 20 cm). Speed mode: Click the SPD and input the required speed on the display (unit: 20-100%) |
| 5 | Start/Pause | Manual mode: hold down the foot pedal to continue producing paper, release the foot pedal then stop; Auto mode: press the foot pedal; |
| 6 | Reset | Press Reset Use when machine is in error (Status: MOTOR/ERROR) 。 |
| 7 | Statistical Functions | Click Statistics to enter the interface, you can view the total length of paper, the total time of power-on, the total number of pedals used, and the number of pedals can be RESET. (The interface is as shown below) |

3. Error code and exclusions

The machine will stop and alarm after detecting the abnormal speed of motor, paper jam and other faults to ensure the safety of the machine and personal safety, the machine is not able to operate before the troubleshooting and the detailed fault alarm information and elimination methods are as follows:

Alarm Alert:

| CONTENT | DETAIL | REASON |
|-------------|------------------------|--|
| MOTOR ERROR | Feed drive abnormality | rubber roller slip or rubber roller wear because of paper jam |
| | | Code disc or photoelectric abnormality |

The troubleshooting process:

- 1.Press Reset button, clear the fault;
- 2.Press the foot pedal again after cleaning the paper inlet , and clear the fault if the machine is running normally (please make sure that the machine is powered off during the process of cleaning the paper jam)

4. Specification

The dimensions are the maximum space size.

4.1 Basic specification

Parameter of the machine:

Weight: 30KG

Size: 706(L)*471(W)*342(H)mm

Packaging dimension :

750(L)*440(W)*380(H)mm

Speed: 0.45m/s

Single length range

: ≥ 20 cm

Lifetime of machine : 3year

Lifetime of wearing part: 1year (cutter)

Foot pedal:

Weight: 0.26kg

Dimension: 103*67*29mm

Wire length: 6m

Electrical connection :

Voltage: 200~240VAC/100~120VAC

Detailed parameter is on the label of machine

Frequency: 50/60Hz

Rate: 100W

Safety:

Warning label: there is a clear warning label for dangerous locations;

Safety protection: please check the CE certified protection standards for protection as there is a winding action.

The safe dimensions of the channel entrance meet CE certification standard.

4.2 Material Specification

Die-cut craft paper:

GSM: 80gr/m²

Length: 250m

Width: 500mm;

Weight: 10kg

MG tissue paper:

GSM: 17~22g gr/m²

Length: 840m

Width: 300mm

Weight: ≈ 5.5 kg

5. Transport and Storage

5.1 Transport

1. The machine shall not have serious vibration or shock during the transportation
2. The machine shall not be exposed to rain and sun and shall be stored in a temperature range of -25 to 55 degrees C (-13 to 131 degrees F) with a relative humidity of less than 90% RH.

5.2 Storage

The storage room must be dry

- The converter must not be set up or stored in a place where it is subject to moisture or water
- Before using the converter after a long storage period, it must be inspected by a trained service technician

6. Maintenance and Repair

6.1 Maintenance

Before performing maintenance on the converter, the electrical supply must be turned off by pulling the power plug from the wall socket.

- Pay attention to sharp edges and corners of the converter due to the risk of cutting.
- Do not operate the converter when the safety devices are switched off or removed.

Cleaning of the converter should be performed at least once a week:

- Remove dust from drawers.
- Check and clean whether there is paper entanglement on the rubber roller.
- Wipe with a dry cloth to remove excess paper dust.

At least once a year the converter needs to be inspected by a qualified person.

The following points need to be checked:

- Various converter adjustments
- Operation of the safety provisions
- Legibility of the warning stickers
- Wear and tear of parts
- Clean cutting area

6.2 Repair / Replacing Parts

Repairs can only be carried out by a qualified service technician.

- Only Lockedpaper supplied parts are permitted for use as replacement parts.
- Parts can be ordered by a Lockedpaper distributor.
- Deviating from the instructions above can affect the safety of the converter. The manufacturer cannot accept liability for such deviations

7. Appendix

7.1 Dimension drawing of machine assembly

